



Dealers Industrial Equipment

No.:

Date: 27-SEP-2016

Customer :

TECHNICAL PROPOSAL

Three-phase induction motor - Squirrel cage rotor

Product line : Oil Well Pumping : High Slip - NEMA Design "D" - ODP

Catalog Number : 10012OS3EOW445T

List Price : \$13,078

Notes:

Downloaded from <http://dealerselectric.com>

Generated for Model #10012OS3EOW445T

Performed by:

Checked:



Dealers Industrial Equipment

No.:

Date: 27-SEP-2016

DATA SHEET

Three-phase induction motor - Squirrel cage rotor

Customer :
 Product line : Oil Well Pumping : High Slip - NEMA Design "D" - ODP

Frame : 445T
 Output : 100 HP
 Frequency : 60 Hz
 Poles : 6
 Full load speed : 1130 rpm
 Slip : 5.83 %
 Voltage : 208-230/460 V
 Rated current : 281-254/127 A
 Locked rotor current : 1450/724 A
 Locked rotor current (I_L/I_n) : 5.7
 No-load current : 112/56.0 A
 Full load torque : 458 lb.ft
 Locked rotor torque : 280 %
 Breakdown torque : 0 %
 Design : D
 Insulation class : F
 Temperature rise : 80 K
 Locked rotor time : 44 s (hot)
 Service factor : 1.00
 Duty cycle : S1
 Ambient temperature : -20°C - +40°C
 Altitude : 1000 m
 Degree of Protection : IP23
 Approximate weight : 1742 lb
 Moment of inertia : 81.806 sq.ft.lb
 Noise level : 77 dB(A)

	D.E.	N.D.E.	Load	Power factor	Efficiency (%)
Bearings	NU-319 C3	6316 C3	100%	0.82	90.2
Regreasing interval	20000 h	20000 h	75%	0.75	90.0
Grease amount	45 g	34 g	50%	0.64	89.7

Notes:
 Downloaded from <http://dealerselectric.com>
 Generated for Model #10012OS3EOW445T

Performed by

Checked



Dealers Industrial Equipment

No.:

Date: 27-SEP-2016

PERFORMANCE CURVES RELATED TO RATED OUTPUT

Three-phase induction motor - Squirrel cage rotor

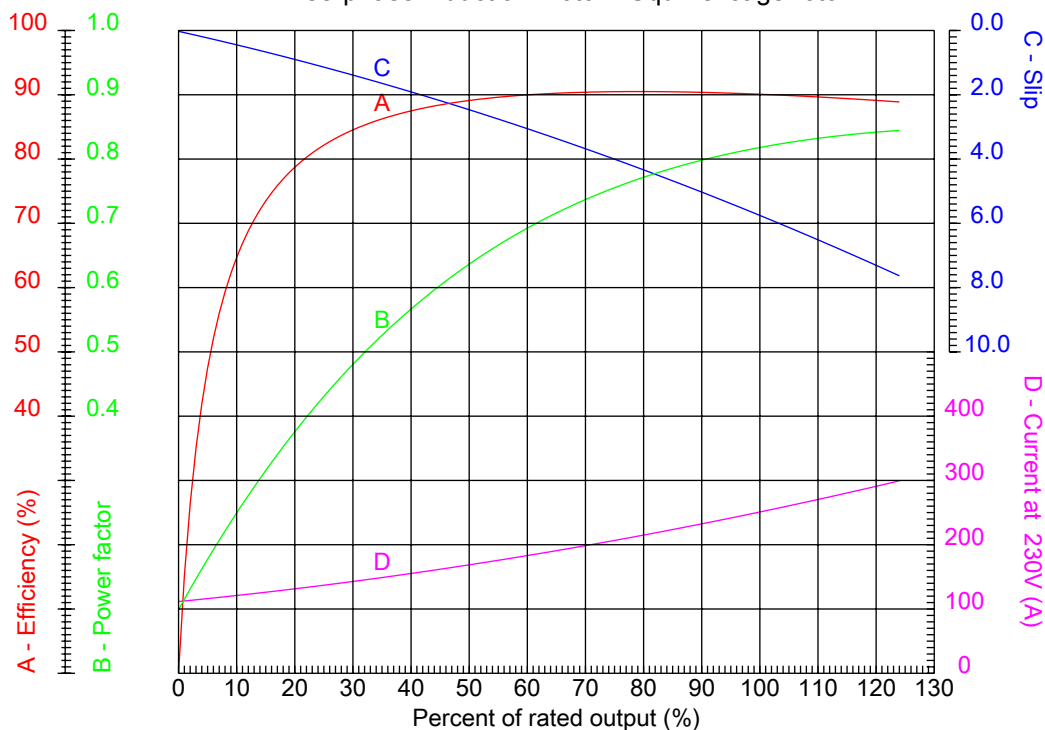

Customer :
Product line : Oil Well Pumping : High Slip - NEMA Design "D" - ODP

Frame : 445T	Locked rotor current (I _L /I _n) : 5.7
Output : 100 HP	Duty cycle : S1
Frequency : 60 Hz	Service factor : 1.00
Full load speed : 1130 rpm	Design : D
Voltage : 208-230/460 V	Locked rotor torque : 280 %
Rated current : 281-254/127 A	Breakdown torque : 0 %
Insulation class : F	

Notes:
Downloaded from <http://dealerselectric.com>
Generated for Model #10012OS3EOW445T

Performed by

Checked



Dealers Industrial Equipment

No.:

Date: 27-SEP-2016

CHARACTERISTIC CURVES RELATED TO SPEED

Three-phase induction motor - Squirrel cage rotor

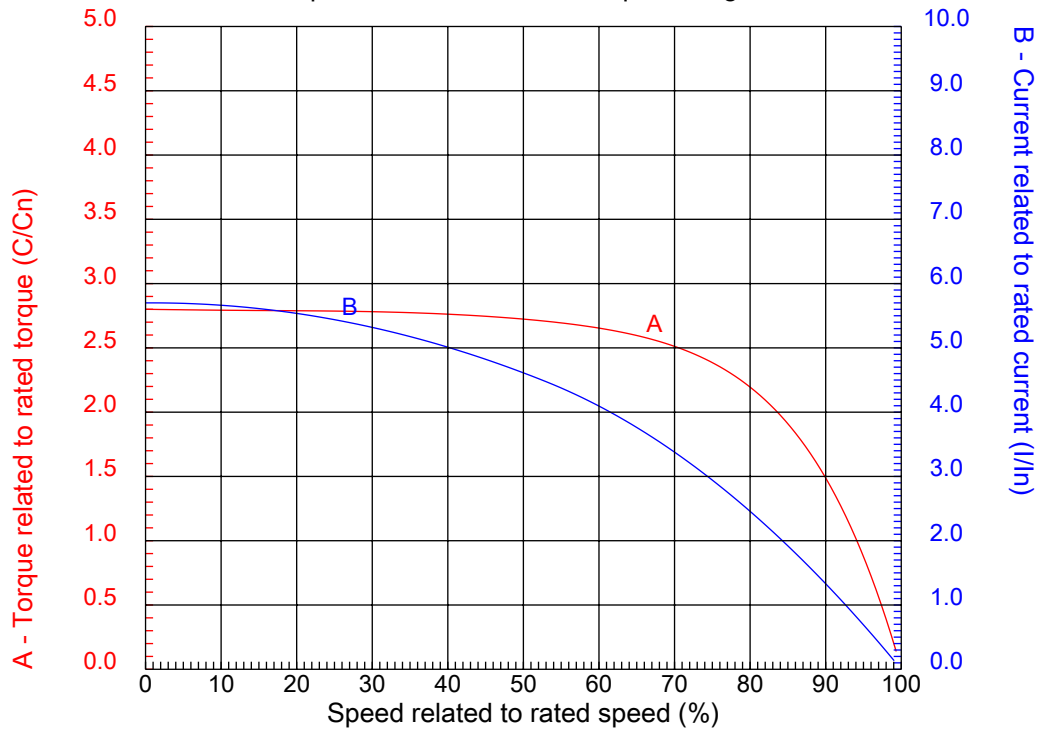

Customer :
Product line : Oil Well Pumping : High Slip - NEMA Design "D" - ODP

Frame	: 445T	Locked rotor current (I _l /I _n)	: 5.7
Output	: 100 HP	Duty cycle	: S1
Frequency	: 60 Hz	Service factor	: 1.00
Full load speed	: 1130 rpm	Design	: D
Voltage	: 208-230/460 V	Locked rotor torque	: 280 %
Rated current	: 281-254/127 A	Breakdown torque	: 238 %
Insulation class	: F		

Notes:
Downloaded from <http://dealerselectric.com>
Generated for Model #10012OS3EOW445T

Performed by

Checked

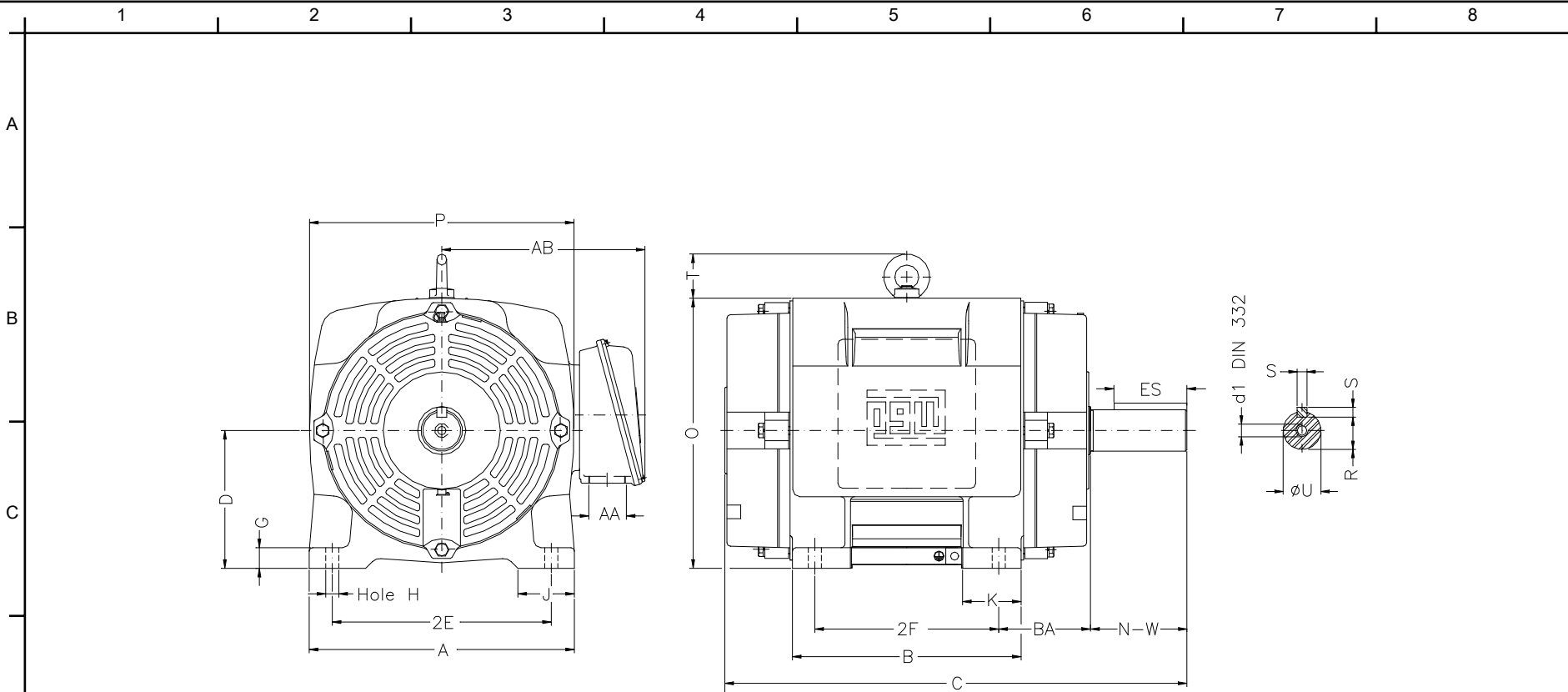

Notes: Downloaded from <http://dealerselectric.com>
 Generated for Model #10012OS3EOW445T

Performed by:

Checked:

Customer:

Oil Well Pumping : High Slip - NEMA Design "D" - ODP

Three-phase induction motor
 Frame 445T - IP23

27-SEP-2016



2E 18.000	A 21.929	2F 14.500/16.500	B 20.078	BA 7.500
J 3.937	K 5.590	P 22.125	ES 7.087	depth 0.875
S 0.875	N-W 8.500	U 3.375	R 2.880	AB 20.236
D 11.000	G 1.811	O 22.440	T 3.544	H 0.807
C 39.803	AA 2xNPT 3"	d1 DUNC 3/4"-10	d2 DUNC 3/4"-10	

1 2 3 4 5 6 7 8

A
B
C
D
E
F

LOW VOLTAGE

HIGH VOLTAGE

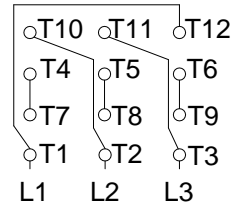
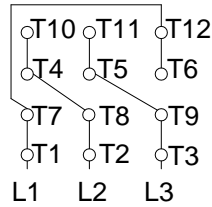

CONNECTIONS FOR STARTING ONLY:

LOW VOLTAGE

HIGH VOLTAGE

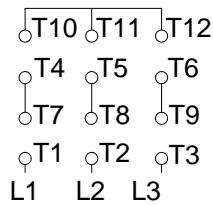
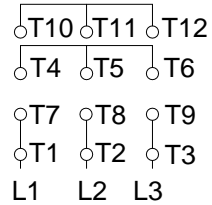

Notes: Downloaded from <http://dealerselectric.com>
Generated for Model #10012OS3EOW445T

Performed by:

Checked:

Customer:

Oil Well Pumping : High Slip - NEMA Design "D" - ODP

Three-phase induction motor
Frame 445T - IP23

27-SEP-2016

