



# Dealers Industrial Equipment

No.:

Date: 13-SEP-2016

Customer :

## TECHNICAL PROPOSAL

### Three-phase induction motor - Squirrel cage rotor

Product line : Three-Phase: Fractional Explosion Proof Motors

Catalog Number : 00336XS3E56H

List Price : \$1,386

#### Notes:

Downloaded from <http://dealerselectric.com>

Generated for Model #00336XS3E56H

Performed by:

Checked:



# Dealers Industrial Equipment

No.:

Date: 13-SEP-2016

## DATA SHEET Three-phase induction motor - Squirrel cage rotor

Customer :  
Product line : Three-Phase: Fractional Explosion Proof Motors

Frame : 56H  
Output : 3 HP  
Frequency : 60 Hz  
Poles : 2  
Full load speed : 3450 rpm  
Slip : 4.17 %  
Voltage : 208-230/460 V  
Rated current : 8.09-7.32/3.66 A  
Locked rotor current : 57.8/28.9 A  
Locked rotor current (I<sub>L</sub>/I<sub>n</sub>) : 7.9  
No-load current : 2.20/1.10 A  
Full load torque : 4.51 lb.ft  
Locked rotor torque : 270 %  
Breakdown torque : 320 %  
Design : A  
Insulation class : F  
Temperature rise : 80 K  
Locked rotor time : 5 s (hot)  
Service factor : 1.00  
Duty cycle : S1  
Ambient temperature : -20°C - +50°C  
Altitude : 1000 m  
Degree of Protection : IP55  
Approximate weight : 43 lb  
Moment of inertia : 0.02563 sq.ft.lb  
Noise level : ---

	D.E.	N.D.E.
Bearings	6205 ZZ	6203 ZZ
Regreasing interval	---	---
Grease amount	---	---

Load	Power factor	Efficiency (%)
100%	0.92	82.0
75%	0.89	81.0
50%	0.85	80.0

Notes:  
Downloaded from <http://dealerselectric.com>  
Generated for Model #00336XS3E56H

Performed by

Checked



# Dealers Industrial Equipment

No.:

Date: 13-SEP-2016

## PERFORMANCE CURVES RELATED TO RATED OUTPUT

Three-phase induction motor - Squirrel cage rotor

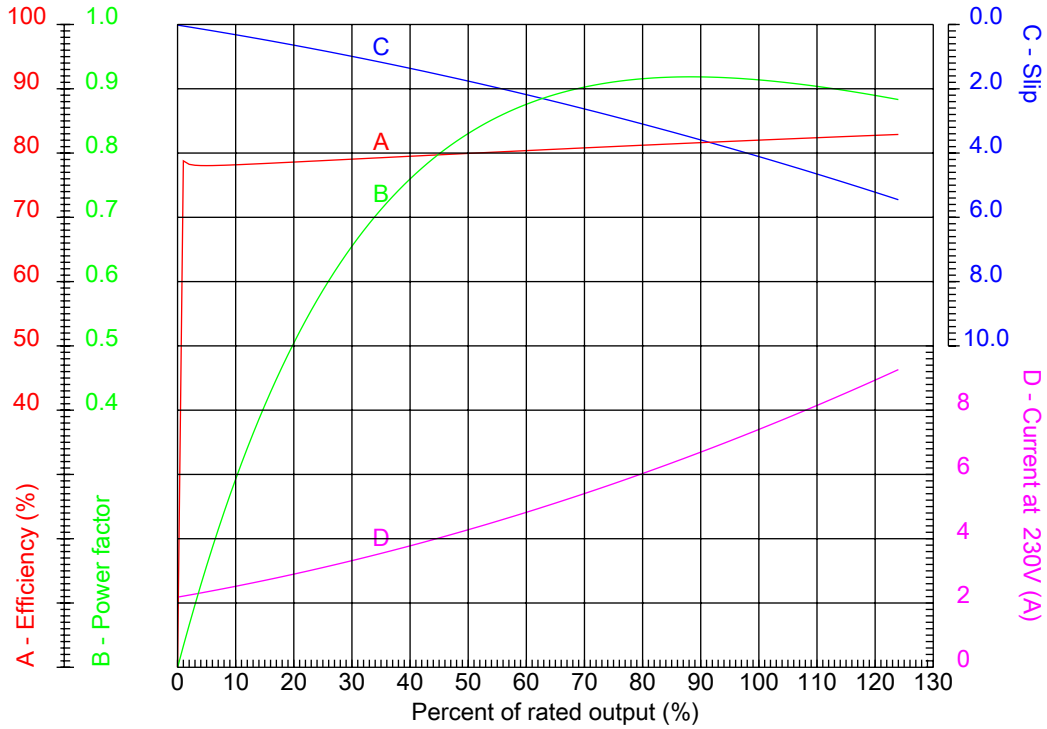

Customer :  
 Product line : Three-Phase: Fractional Explosion Proof Motors

Frame	: 56H	Locked rotor current (I <sub>l</sub> /I <sub>n</sub> )	: 7.9
Output	: 3 HP	Duty cycle	: S1
Frequency	: 60 Hz	Service factor	: 1.00
Full load speed	: 3450 rpm	Design	: A
Voltage	: 208-230/460 V	Locked rotor torque	: 270 %
Rated current	: 8.09-7.32/3.66 A	Breakdown torque	: 320 %
Insulation class	: F		

Notes:  
 Downloaded from <http://dealerselectric.com>  
 Generated for Model #00336XS3E56H

Performed by

Checked



# Dealers Industrial Equipment

No.:

Date: 13-SEP-2016

## CHARACTERISTIC CURVES RELATED TO SPEED

Three-phase induction motor - Squirrel cage rotor

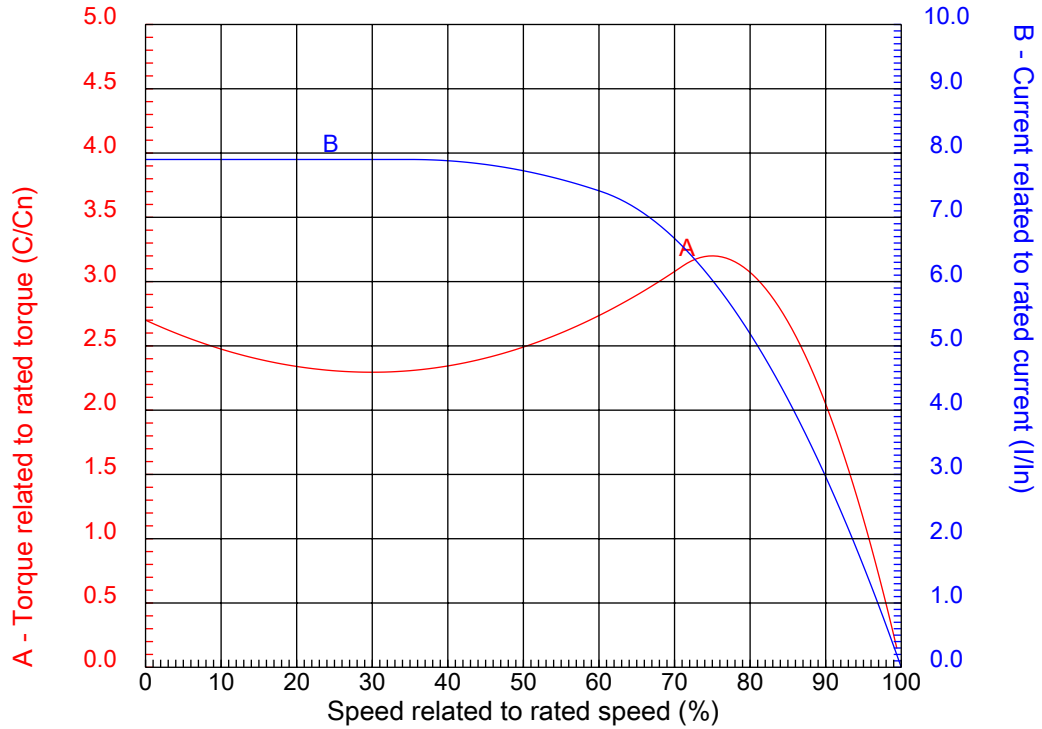

Customer :  
Product line : Three-Phase: Fractional Explosion Proof Motors

Frame	: 56H	Locked rotor current (I <sub>l</sub> /I <sub>n</sub> )	: 7.9
Output	: 3 HP	Duty cycle	: S1
Frequency	: 60 Hz	Service factor	: 1.00
Full load speed	: 3450 rpm	Design	: A
Voltage	: 208-230/460 V	Locked rotor torque	: 270 %
Rated current	: 8.09-7.32/3.66 A	Breakdown torque	: 320 %
Insulation class	: F		

Notes:  
Downloaded from <http://dealerselectric.com>  
Generated for Model #00336XS3E56H

Performed by

Checked

1 2 3 4 5 6 7 8

A

B

C

D

E

F

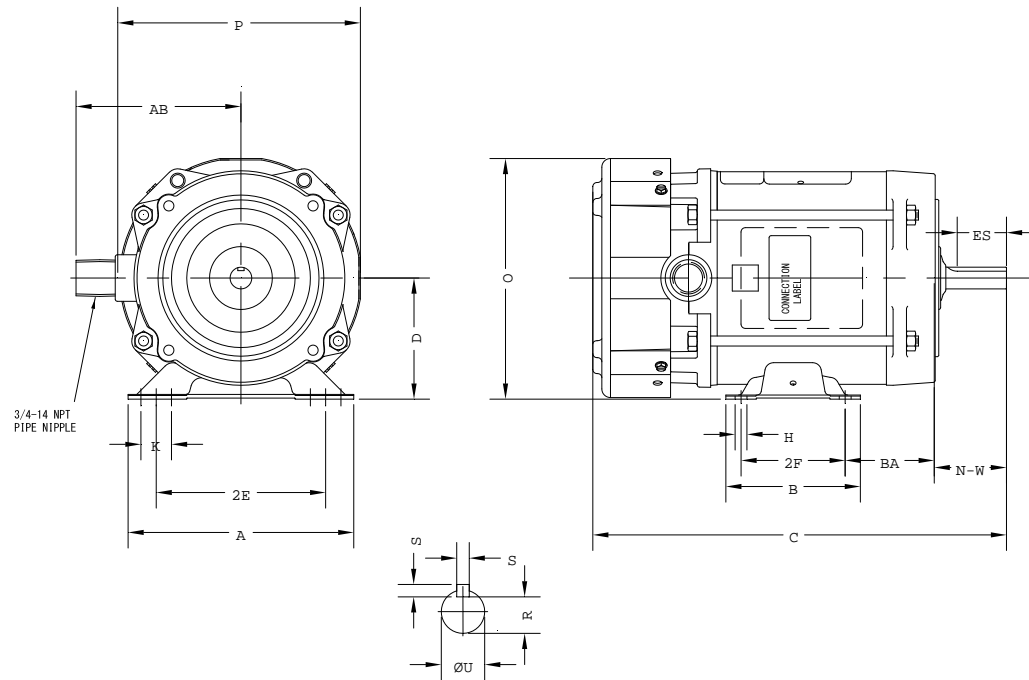

Notes: Downloaded from <http://dealerselectric.com>  
Generated for Model #00336XS3E56H

Performed by:

Checked:

Customer:

Three-Phase: Fractional Explosion Proof Motors

Three-phase induction motor  
Frame 56H - IP55

13-SEP-2016



2E 4.880	A 6.500	P 6.980	AB 4.500	B 5.880
BA 2.750	U 0.6250	N-W 1.880	ES 1.380	S 0.190
R 0.517	D 3.500	O 6.920	H 0.340	C 14.420
d1 SEM	2F 3.000/5.000			