



Dealers Industrial Equipment

No.:

Date: 13-SEP-2016

Customer :

TECHNICAL PROPOSAL

Single-phase induction motor - Squirrel cage rotor

Product line : Single-Phase : NEMA 48 & 56 ODP - Start Capacitor

Catalog Number : 00336OS1BG56CFL

List Price : \$496

Notes:

Downloaded from <http://dealerselectric.com>

Generated for Model #00336OS1BG56CFL

Performed by:

Checked:



Dealers Industrial Equipment

No.:

Date: 13-SEP-2016

DATA SHEET Single-phase induction motor - Squirrel cage rotor

Customer :
 Product line : Single-Phase : NEMA 48 & 56 ODP - Start Capacitor

Frame : G56H
 Output : 3 HP
 Frequency : 60 Hz
 Poles : 2
 Full load speed : 3490 rpm
 Slip : 3.06 %
 Voltage : 208-230 V
 Rated current : 16.0-15.5 A
 Locked rotor current : 109 A
 Locked rotor current (I_L/I_n) : 7.0
 No-load current : 8.50 A
 Full load torque : 4.45 lb.ft
 Locked rotor torque : 230 %
 Breakdown torque : 250 %
 Design : ---
 Insulation class : B
 Temperature rise : 80 K
 Locked rotor time : 6 s (hot)
 Service factor : 1.00 (1.00 at 208V)
 Duty cycle : S1
 Ambient temperature : -20°C - +40°C
 Altitude : 1000 m
 Degree of Protection : IP21
 Approximate weight : 42 lb
 Moment of inertia : 0.07214 sq.ft.lb
 Noise level : ---

	D.E.	N.D.E.	Load	Power factor	Efficiency (%)
Bearings	6204 ZZ	6203 ZZ	100%	0.80	78.0
Regreasing interval	---	---	75%	0.73	78.0
Grease amount	---	---	50%	0.61	75.0

Notes:
 Downloaded from <http://dealerselectric.com>
 Generated for Model #00336OS1BG56CFL

Performed by

Checked



Dealers Industrial Equipment

No.:

Date: 13-SEP-2016

PERFORMANCE CURVES RELATED TO RATED OUTPUT

Single-phase induction motor - Squirrel cage rotor

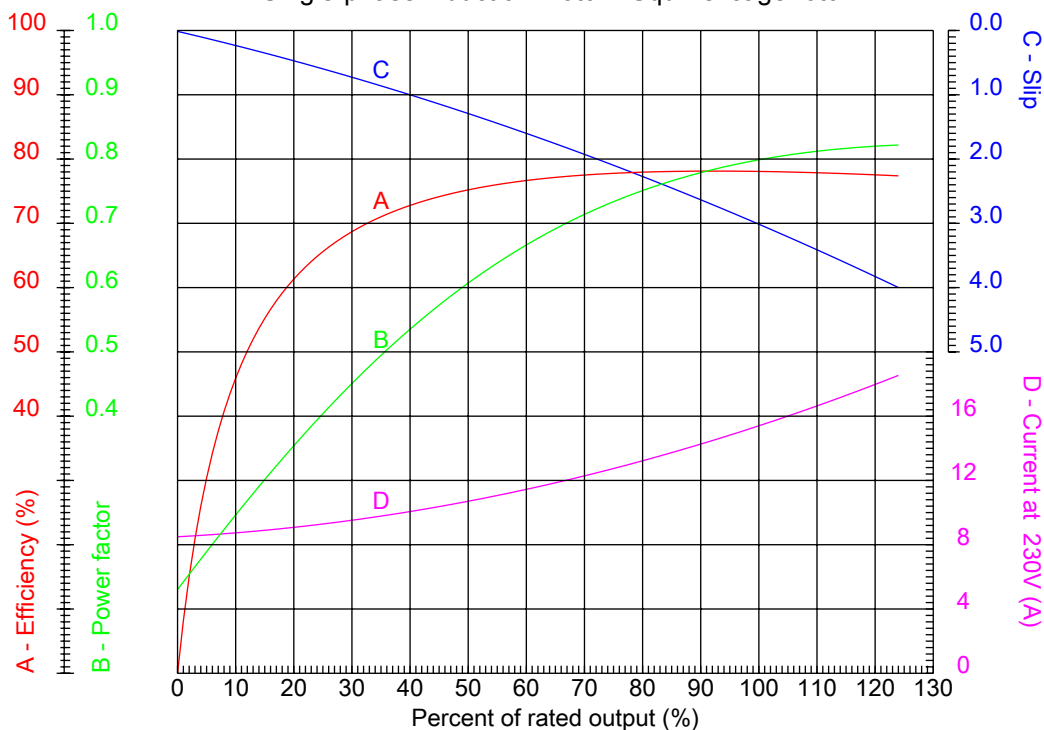

Customer :
 Product line : Single-Phase : NEMA 48 & 56 ODP - Start Capacitor

Frame	: G56H	Locked rotor current (I _l /I _n)	: 7.0
Output	: 3 HP	Duty cycle	: S1
Frequency	: 60 Hz	Service factor	: 1.00 (1.00 at 208V)
Full load speed	: 3490 rpm	Design	: ---
Voltage	: 208-230 V	Locked rotor torque	: 230 %
Rated current	: 16.0-15.5 A	Breakdown torque	: 250 %
Insulation class	: B		

Notes:
 Downloaded from <http://dealerselectric.com>
 Generated for Model #00336OS1BG56CFL

Performed by

Checked

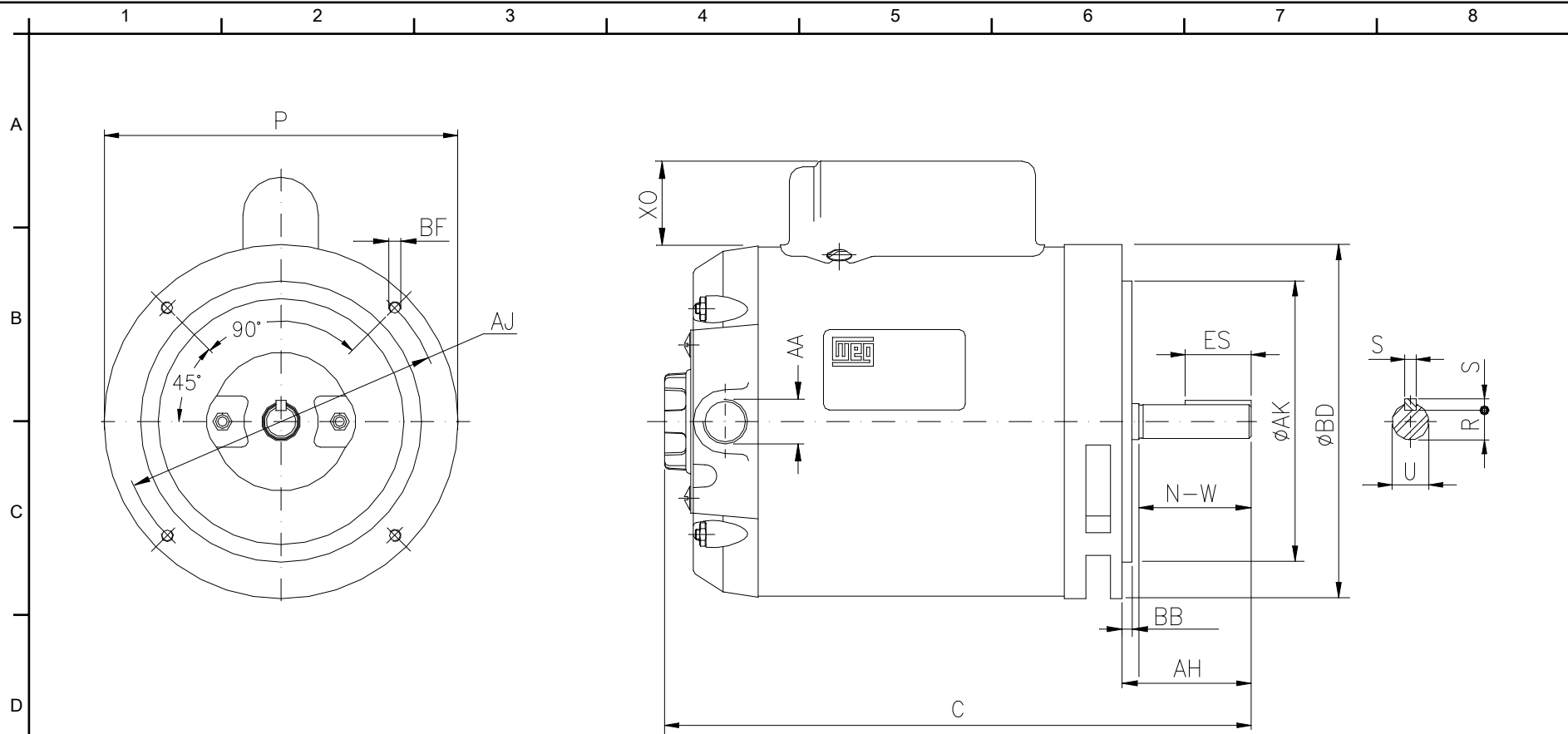

Notes: Downloaded from <http://dealerselectric.com>
 Generated for Model #00336OS1BG56CFL

Performed by:

Checked:

Customer:

Single-Phase : NEMA 48 & 56 ODP - Start Capacitor

C	P	ES	S	N-W
13.858	6.457	1.102	0.187	1.874
U	R	AA	d1	AH
0.6250	0.517	NPT 1/2"	A 3.15	2.063
Flange	AJ	AK	BD	BF
FC-149	5.874	4.500	6.500	UNC 3/8"x16-2B
BB				
0.157				

Single-phase induction motor
 Frame G56H - IP21

13-SEP-2016

