



Dealers Industrial Equipment

No.:

Date: 12-SEP-2016

Customer :

TECHNICAL PROPOSAL

Three-phase induction motor - Squirrel cage rotor

Product line : Jet Pump - NEMA 56 : Three-Phase - Keyed - TEFC (IP55)

Catalog Number : 00336ES3EJPR56C

List Price : \$480

Notes:

Downloaded from <http://dealerselectric.com>

Generated for Model #00336ES3EJPR56C

Performed by:

Checked:



Dealers Industrial Equipment

No.:

Date: 12-SEP-2016

DATA SHEET Three-phase induction motor - Squirrel cage rotor

Customer :
 Product line : Jet Pump - NEMA 56 : Three-Phase - Keyed - TEFC (IP55)

Frame : F56HC
 Output : 3 HP
 Frequency : 60 Hz
 Poles : 2
 Full load speed : 3450 rpm
 Slip : 4.17 %
 Voltage : 208-230/460 V
 Rated current : 8.25-7.60/3.80 A
 Locked rotor current : 73.0/36.5 A
 Locked rotor current (I_L/I_n) : 9.6
 No-load current : 3.20/1.60 A
 Full load torque : 4.51 lb.ft
 Locked rotor torque : 430 %
 Breakdown torque : 380 %
 Design : A
 Insulation class : F
 Temperature rise : 80 K
 Locked rotor time : 10 s (hot)
 Service factor : 1.15 (1.00 at 208V)
 Duty cycle : S1
 Ambient temperature : -20°C - +40°C
 Altitude : 1000 m
 Degree of Protection : IP55
 Approximate weight : 43 lb
 Moment of inertia : 0.08638 sq.ft.lb
 Noise level : ---

	D.E.	N.D.E.
Bearings	6204 2RS	6203 2RS
Regreasing interval	---	---
Grease amount	---	---

Load	Power factor	Efficiency (%)
100%	0.89	84.0
75%	0.84	84.0
50%	0.74	82.0

Notes:
 Downloaded from <http://dealerselectric.com>
 Generated for Model #00336ES3EJPR56C

Performed by

Checked



Dealers Industrial Equipment

No.:

Date: 12-SEP-2016

PERFORMANCE CURVES RELATED TO RATED OUTPUT

Three-phase induction motor - Squirrel cage rotor

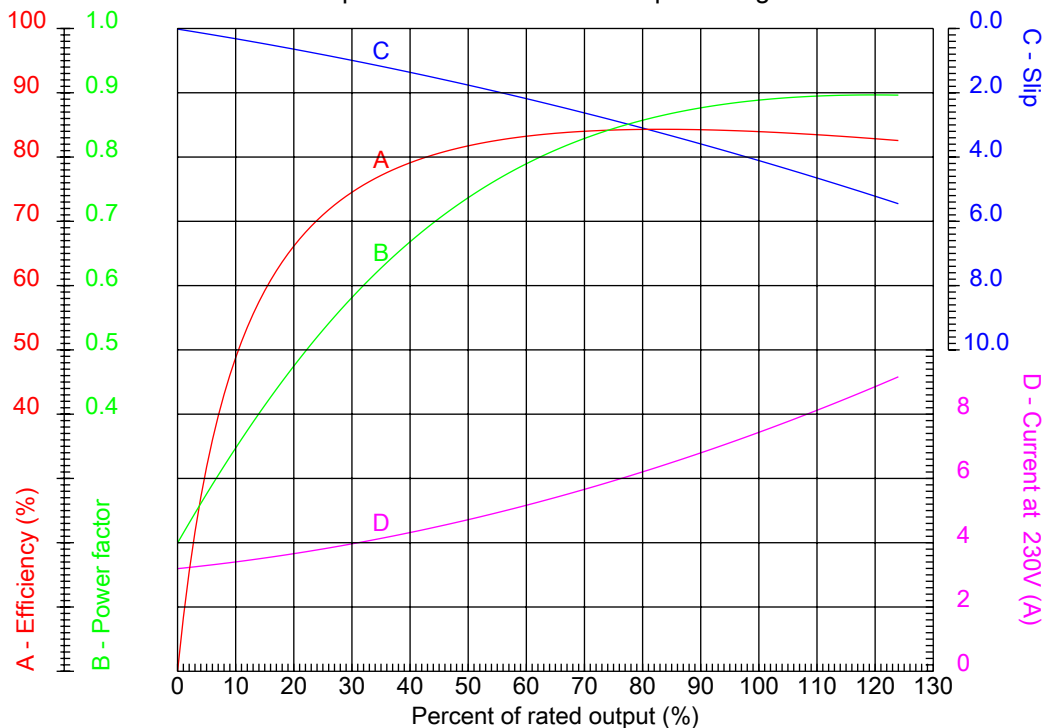

Customer :
Product line : Jet Pump - NEMA 56 : Three-Phase - Keyed - TEFC (IP55)

Frame : F56HC	Locked rotor current (I _l /I _n) : 9.6
Output : 3 HP	Duty cycle : S1
Frequency : 60 Hz	Service factor : 1.15 (1.00 at 208V)
Full load speed : 3450 rpm	Design : A
Voltage : 208-230/460 V	Locked rotor torque : 430 %
Rated current : 8.25-7.60/3.80 A	Breakdown torque : 380 %
Insulation class : F	

Notes:
Downloaded from <http://dealerselectric.com>
Generated for Model #00336ES3EJPR56C

Performed by

Checked



Dealers Industrial Equipment

No.:

Date: 12-SEP-2016

CHARACTERISTIC CURVES RELATED TO SPEED

Three-phase induction motor - Squirrel cage rotor

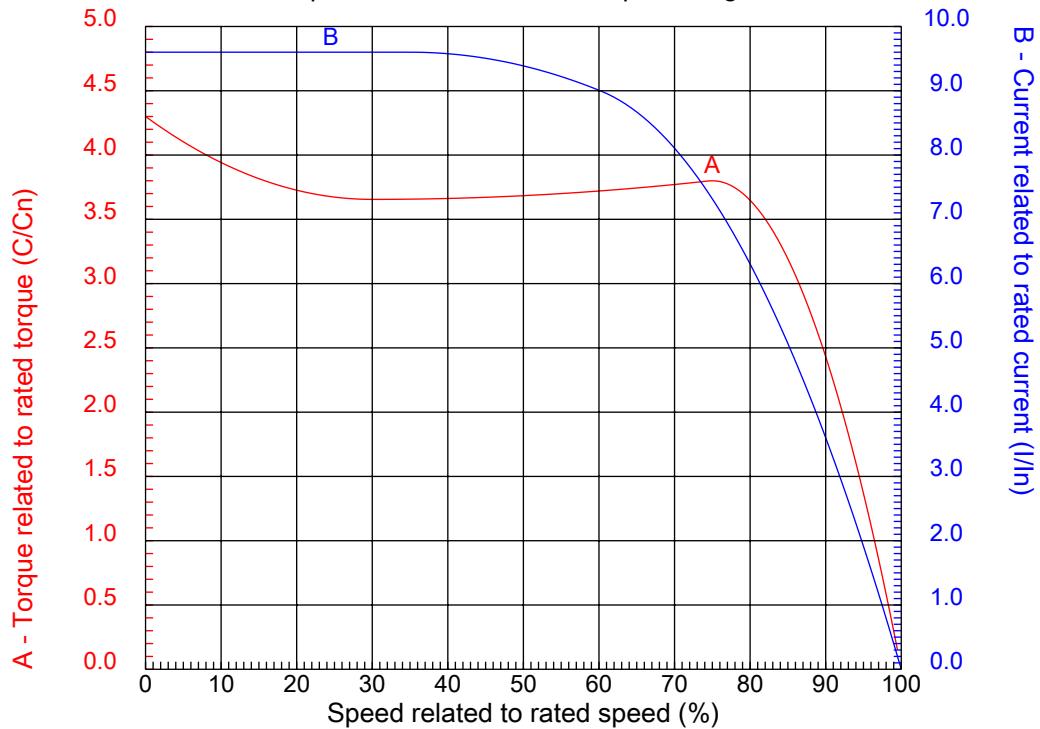

Customer :
Product line : Jet Pump - NEMA 56 : Three-Phase - Keyed - TEFC (IP55)

Frame	: F56HC	Locked rotor current (I _l /I _n)	: 9.6
Output	: 3 HP	Duty cycle	: S1
Frequency	: 60 Hz	Service factor	: 1.15 (1.00 at 208V)
Full load speed	: 3450 rpm	Design	: A
Voltage	: 208-230/460 V	Locked rotor torque	: 430 %
Rated current	: 8.25-7.60/3.80 A	Breakdown torque	: 380 %
Insulation class	: F		

Notes:
Downloaded from <http://dealerselectric.com>
Generated for Model #00336ES3EJPR56C

Performed by

Checked

1 2 3 4 5 6 7 8

A

B

C

D

E

F

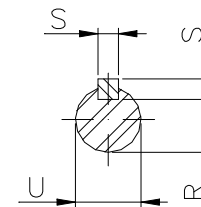
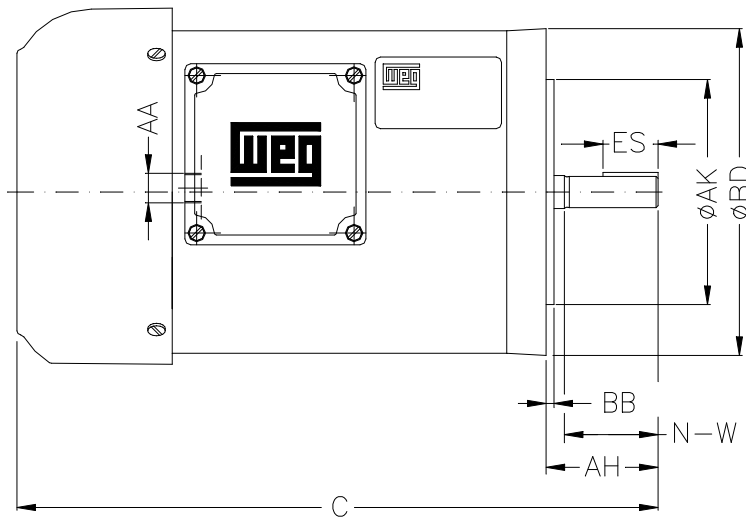
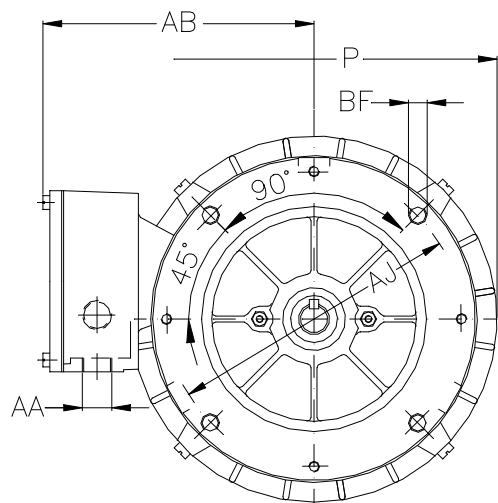

Notes: Downloaded from <http://dealerselectric.com>
Generated for Model #00336ES3EJPR56C

Performed by:

Checked:

Customer:

Jet Pump - NEMA 56 : Three-Phase - Keyed - TEFC (IP55)

C 13.464	P 7.323	ES 1.417	S 0.187	N-W 1.874
U 0.6250	R 0.517	AB 5.433	AA NPT 1/2"	Flange FC-149
AJ 5.874	AK 4.500	BD 6.535	BF UNC 3/8"x16-2B	BB 0.157
AH 2.063				

Three-phase induction motor
Frame F56HC - IP55

12-SEP-2016



1 2 3 4 5 6 7 8

A

LOW VOLTAGE

HIGH VOLTAGE

B



C

L1 L2 L3

L1 L2 L3



D

E

F

Notes: Downloaded from <http://dealerselectric.com>
 Generated for Model #00336ES3EJPR56C

Performed by:

Checked:

Customer:

Jet Pump - NEMA 56 : Three-Phase - Keyed - TEFC (IP55)

Three-phase induction motor
Frame F56HC - IP55

12-SEP-2016

