



Dealers Industrial Equipment

No.:

Date: 12-SEP-2016

Customer :

TECHNICAL PROPOSAL

Single-phase induction motor - Squirrel cage rotor

Product line : Single-Phase : NEMA 48 & 56 ODP - Start Capacitor

Catalog Number : 00236OS1BF56CFL

List Price : \$432

Notes:

Downloaded from <http://dealerselectric.com>

Generated for Model #00236OS1BF56CFL

Performed by:

Checked:



Dealers Industrial Equipment

No.:

Date: 12-SEP-2016

DATA SHEET

Single-phase induction motor - Squirrel cage rotor

Customer :
Product line : Single-Phase : NEMA 48 & 56 ODP - Start Capacitor

Frame : F56H
Output : 2 HP
Frequency : 60 Hz
Poles : 2
Full load speed : 3525 rpm
Slip : 2.08 %
Voltage : 115/208-230 V
Rated current : 21.9/11.3-11.0 A
Locked rotor current : 175/87.6 A
Locked rotor current (I_L/I_n) : 8.0
No-load current : 14.0/7.00 A
Full load torque : 2.94 lb.ft
Locked rotor torque : 250 %
Breakdown torque : 280 %
Design : ---
Insulation class : B
Temperature rise : 80 K
Locked rotor time : 6 s (hot)
Service factor : 1.15 (1.00 at 208V)
Duty cycle : S1
Ambient temperature : -20°C - +40°C
Altitude : 1000 m
Degree of Protection : IP21
Approximate weight : 42 lb
Moment of inertia : 0.06644 sq.ft.lb
Noise level : ---

	D.E.	N.D.E.	Load	Power factor	Efficiency (%)
Bearings	6204 ZZ	6203 ZZ	100%	0.75	77.9
Regreasing interval	---	---	75%	0.67	76.2
Grease amount	---	---	50%	0.59	71.1

Notes:

Downloaded from <http://dealerselectric.com>
Generated for Model #00236OS1BF56CFL

Performed by

Checked



Dealers Industrial Equipment

No.:

Date: 12-SEP-2016

PERFORMANCE CURVES RELATED TO RATED OUTPUT

Single-phase induction motor - Squirrel cage rotor

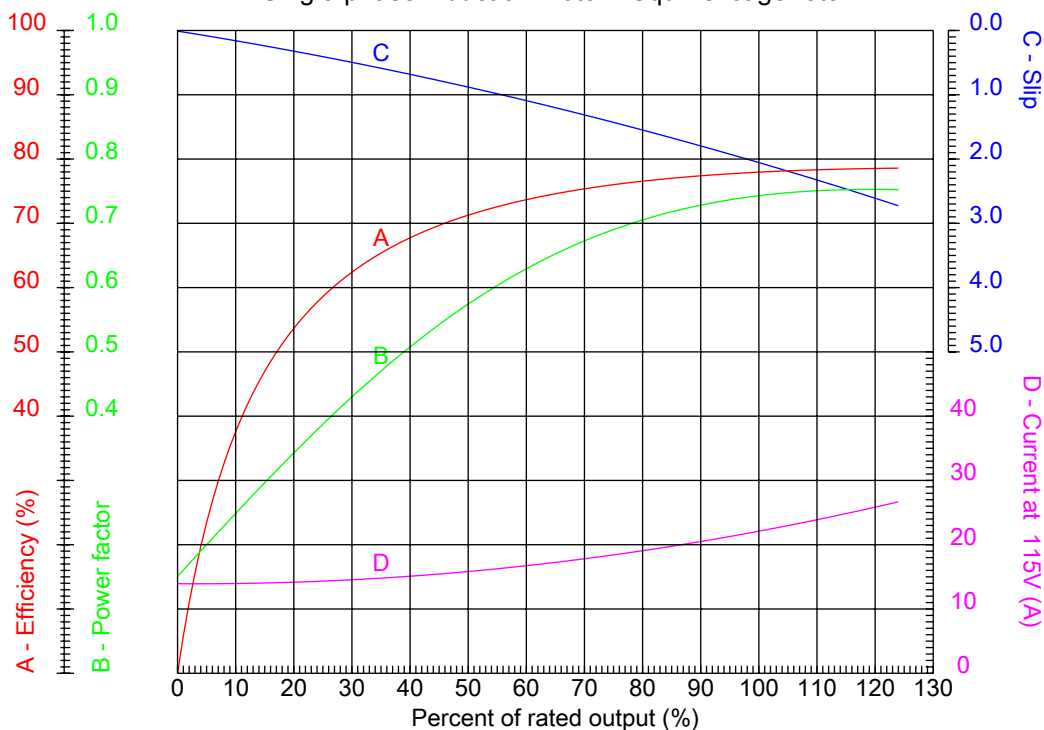

Customer :
Product line : Single-Phase : NEMA 48 & 56 ODP - Start Capacitor

Frame	: F56H	Locked rotor current (I _l /I _n)	: 8.0
Output	: 2 HP	Duty cycle	: S1
Frequency	: 60 Hz	Service factor	: 1.15 (1.00 at 208V)
Full load speed	: 3525 rpm	Design	: ---
Voltage	: 115/208-230 V	Locked rotor torque	: 250 %
Rated current	: 21.9/11.3-11.0 A	Breakdown torque	: 280 %
Insulation class	: B		

Notes:
Downloaded from <http://dealerselectric.com>
Generated for Model #00236OS1BF56CFL

Performed by

Checked

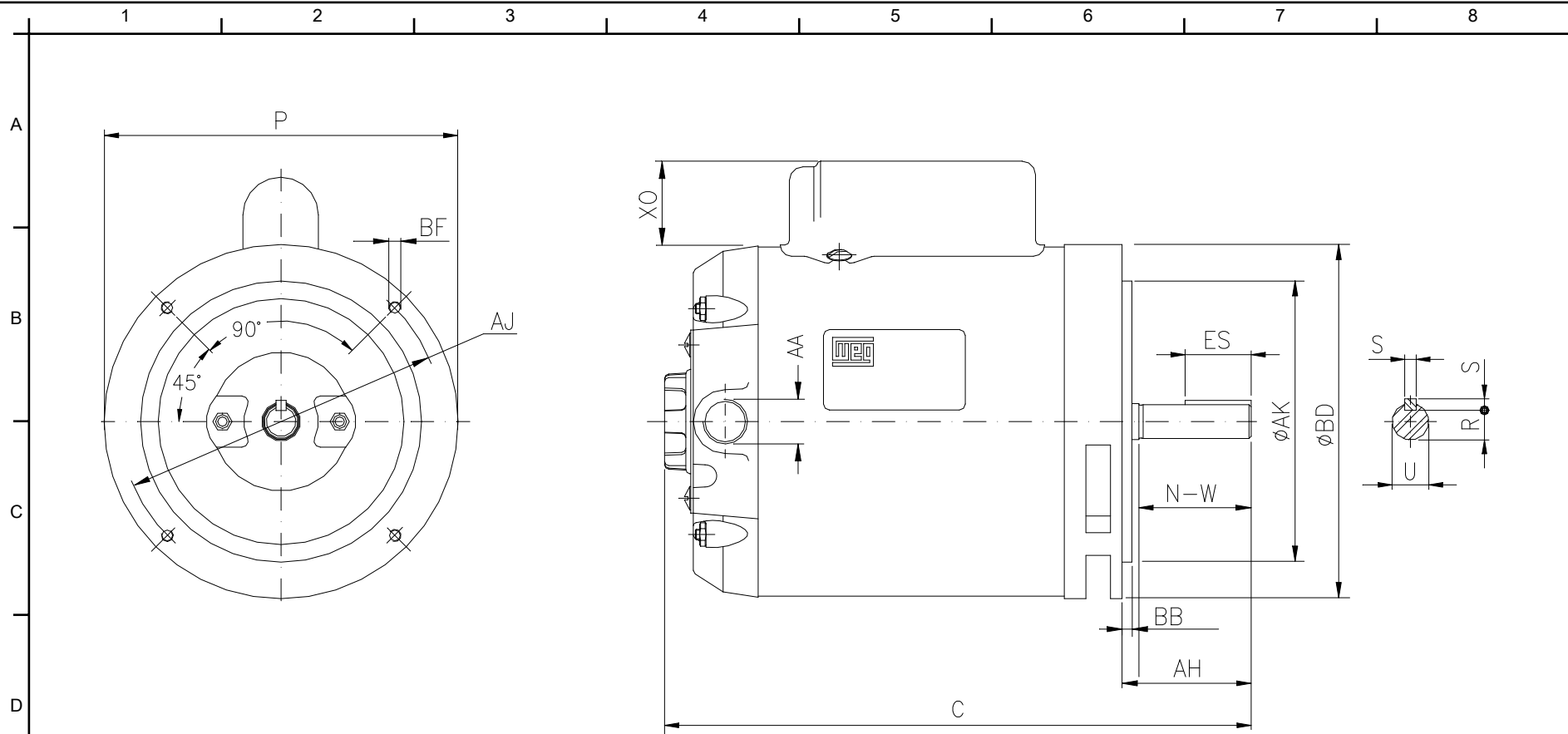

Notes: Downloaded from <http://dealerselectric.com>
 Generated for Model #00236OS1BF56CFL

Performed by:

Checked:

Customer:

Single-Phase : NEMA 48 & 56 ODP - Start Capacitor

C	P	ES	S	N-W
13.464	6.457	1.102	0.187	1.874
U	R	AA	d1	AH
0.6250	0.517	NPT 1/2"	A 3.15	2.063
Flange	AJ	AK	BD	BF
FC-149	5.874	4.500	6.500	UNC 3/8"x16-2B
BB				
0.157				

Single-phase induction motor
 Frame F56H - IP21

12-SEP-2016

