



Dealers Industrial Equipment

No.:

Date: 12-SEP-2016

Customer :

TECHNICAL PROPOSAL

Three-phase induction motor - Squirrel cage rotor

Product line : W22 High Efficiency

Catalog Number : 00156EP3ER143TC-W22

List Price : \$458

Notes:

Downloaded from <http://dealerselectric.com>

Generated for Model #00156EP3ER143TC-W22

Performed by:

Checked:



Dealers Industrial Equipment

No.:

Date: 12-SEP-2016

DATA SHEET Three-phase induction motor - Squirrel cage rotor

Customer :
Product line : W22 High Efficiency

Frame : 143T
Output : 1.5 HP
Frequency : 60 Hz
Poles : 2
Full load speed : 3455 rpm
Slip : 4.03 %
Voltage : 230/460 V
Rated current : 3.98/1.99 A
Locked rotor current : 27.1/13.5 A
Locked rotor current (I_L/I_n) : 6.8
No-load current : 1.80/0.900 A
Full load torque : 2.25 lb.ft
Locked rotor torque : 250 %
Breakdown torque : 300 %
Design : B
Insulation class : F
Temperature rise : 80 K
Locked rotor time : 13 s (hot)
Service factor : 1.25
Duty cycle : S1
Ambient temperature : -20°C - +40°C
Altitude : 1000 m
Degree of Protection : IP55
Approximate weight : 39 lb
Moment of inertia : 0.03702 sq.ft.lb
Noise level : 68 dB(A)

	D.E.	N.D.E.
Bearings	6205 ZZ	6204 ZZ
Regreasing interval	---	---
Grease amount	---	---

Load	Power factor	Efficiency (%)
100%	0.84	82.5
75%	0.78	82.5
50%	0.68	78.5

Notes:
Downloaded from <http://dealerselectric.com>
Generated for Model #00156EP3ER143TC-W22

Performed by

Checked



Dealers Industrial Equipment

No.:

Date: 12-SEP-2016

PERFORMANCE CURVES RELATED TO RATED OUTPUT

Three-phase induction motor - Squirrel cage rotor

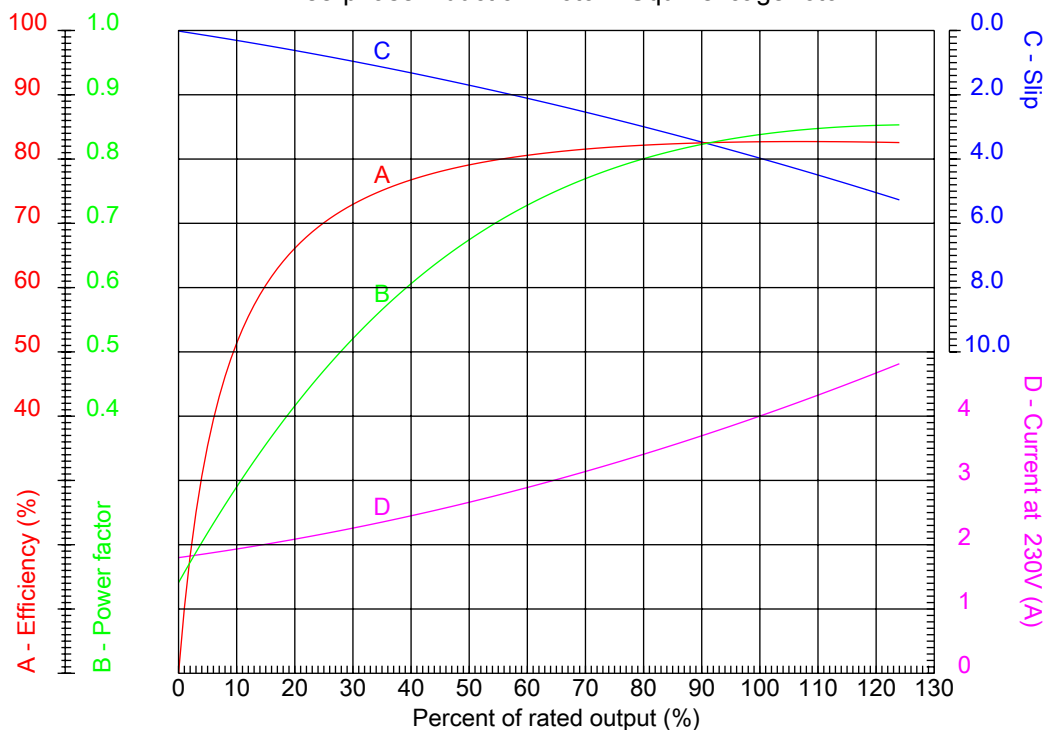

Customer :
Product line : W22 High Efficiency

Frame : 143T	Locked rotor current (I _L /I _n) : 6.8
Output : 1.5 HP	Duty cycle : S1
Frequency : 60 Hz	Service factor : 1.25
Full load speed : 3455 rpm	Design : B
Voltage : 230/460 V	Locked rotor torque : 250 %
Rated current : 3.98/1.99 A	Breakdown torque : 300 %
Insulation class : F	

Notes:
Downloaded from <http://dealerselectric.com>
Generated for Model #00156EP3ER143TC-W22

Performed by

Checked



CHARACTERISTIC CURVES RELATED TO SPEED

Three-phase induction motor - Squirrel cage rotor

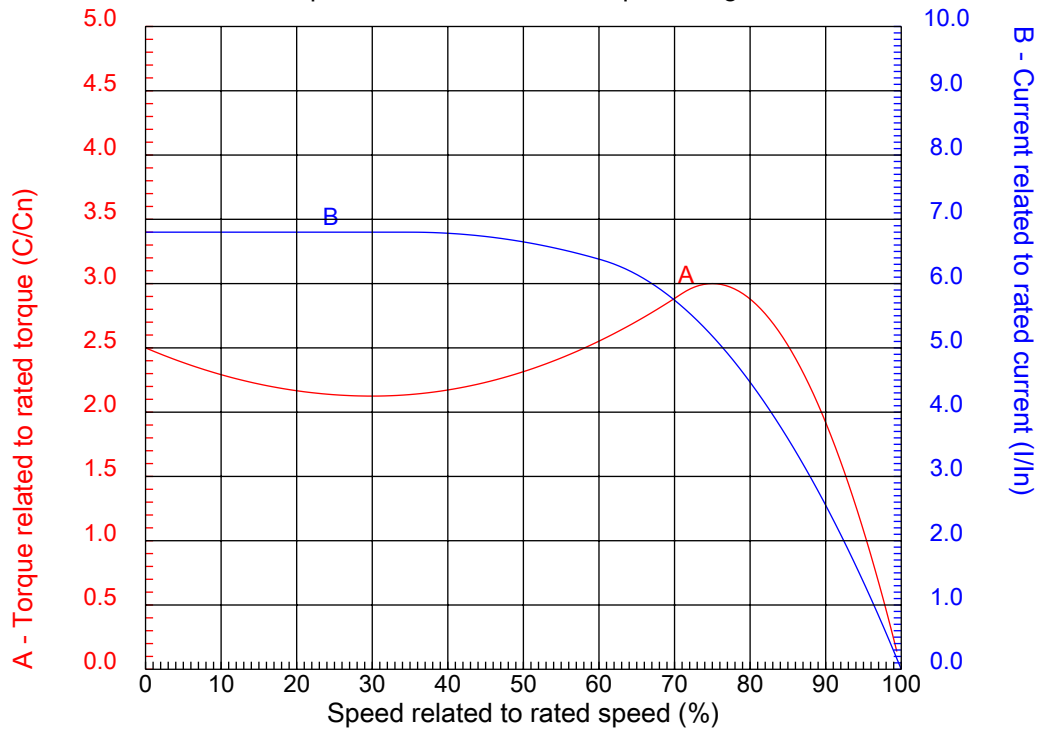

Customer :
Product line : W22 High Efficiency

Frame	: 143T	Locked rotor current (I _l /I _n)	: 6.8
Output	: 1.5 HP	Duty cycle	: S1
Frequency	: 60 Hz	Service factor	: 1.25
Full load speed	: 3455 rpm	Design	: B
Voltage	: 230/460 V	Locked rotor torque	: 250 %
Rated current	: 3.98/1.99 A	Breakdown torque	: 300 %
Insulation class	: F		

Notes:
Downloaded from <http://dealerselectric.com>
Generated for Model #00156EP3ER143TC-W22

Performed by

Checked

1 2 3 4 5 6 7 8

A
B
C
D
E
F

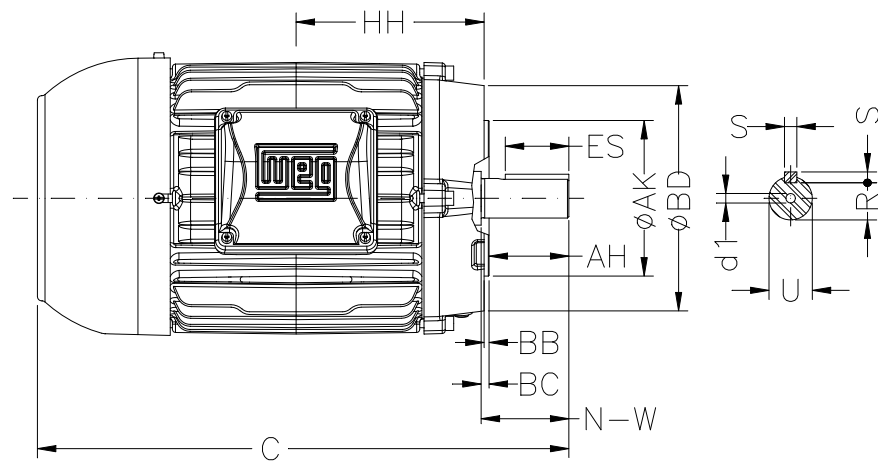
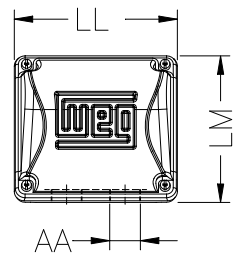
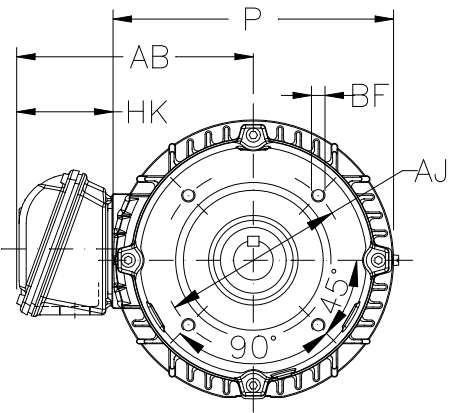

Notes: Downloaded from <http://dealerselectric.com>
Generated for Model #00156EP3ER143TC-W22

Performed by:

Checked:

Customer:

W22 High Efficiency

P	AB	U	N-W	ES
7.244	6.260	0.875	2.250	1.575
S	R	depth	HH	HK
0.187	0.771	0.187	4.250	2.638
C	LL	LM	AA	d1
12.346	4.528	4.094	NPT 3/4"	A 3,15
Flange	AJ	AK	BD	BF
FC-149	5.875	4.500	6.500	UNC 3/8"x16
BB	BC	AH		
0.157	0.125	2.125		

Three-phase induction motor
Frame 143T - IP55

12-SEP-2016



1 2 3 4 5 6 7 8

A

LOW VOLTAGE

HIGH VOLTAGE

B



C

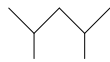

D

E

F

Notes: Downloaded from <http://dealerselectric.com>
 Generated for Model #00156EP3ER143TC-W22

Performed by:

Checked:

Customer:

W22 High Efficiency

Three-phase induction motor
 Frame 143T - IP55

12-SEP-2016

