



Dealers Industrial Equipment

No.:

Date: 12-SEP-2016

Customer :

TECHNICAL PROPOSAL

Three-phase induction motor - Squirrel cage rotor

Product line : Three-Phase : Rolled Steel Motor - NEMA Premium Efficiency

Catalog Number : 00112ET3ERS145TC

List Price : \$>(discontinued)

Notes:

Downloaded from <http://dealerselectric.com>

Generated for Model #00112ET3ERS145TC

Performed by:

Checked:



Dealers Industrial Equipment

No.:

Date: 12-SEP-2016

DATA SHEET Three-phase induction motor - Squirrel cage rotor

Customer :
 Product line : Three-Phase : Rolled Steel Motor - NEMA Premium Efficiency

Frame : 143/5T
 Output : 1 HP
 Frequency : 60 Hz
 Poles : 6
 Full load speed : 1160 rpm
 Slip : 3.33 %
 Voltage : 208-230/460 V
 Rated current : 3.55-3.50/1.75 A
 Locked rotor current : 20.0/9.98 A
 Locked rotor current (I_L/I_n) : 5.7
 No-load current : 2.40/1.20 A
 Full load torque : 4.47 lb.ft
 Locked rotor torque : 250 %
 Breakdown torque : 300 %
 Design : B
 Insulation class : F
 Temperature rise : 80 K
 Locked rotor time : 15 s (hot)
 Service factor : 1.15 (1.00 at 208V)
 Duty cycle : S1
 Ambient temperature : -20°C - +40°C
 Altitude : 1000 m
 Degree of Protection : IP55
 Approximate weight : 41 lb
 Moment of inertia : 0.17679 sq.ft.lb
 Noise level : ---

| | D.E. | N.D.E. |
|---------------------|---------|---------|
| Bearings | 6205 ZZ | 6203 ZZ |
| Regreasing interval | --- | --- |
| Grease amount | --- | --- |

| Load | Power factor | Efficiency (%) |
|------|--------------|----------------|
| 100% | 0.65 | 82.5 |
| 75% | 0.55 | 81.5 |
| 50% | 0.43 | 78.5 |

Notes:
 Downloaded from <http://dealerselectric.com>
 Generated for Model #00112ET3ERS145TC

Performed by

Checked



Dealers Industrial Equipment

No.:

Date: 12-SEP-2016

PERFORMANCE CURVES RELATED TO RATED OUTPUT

Three-phase induction motor - Squirrel cage rotor

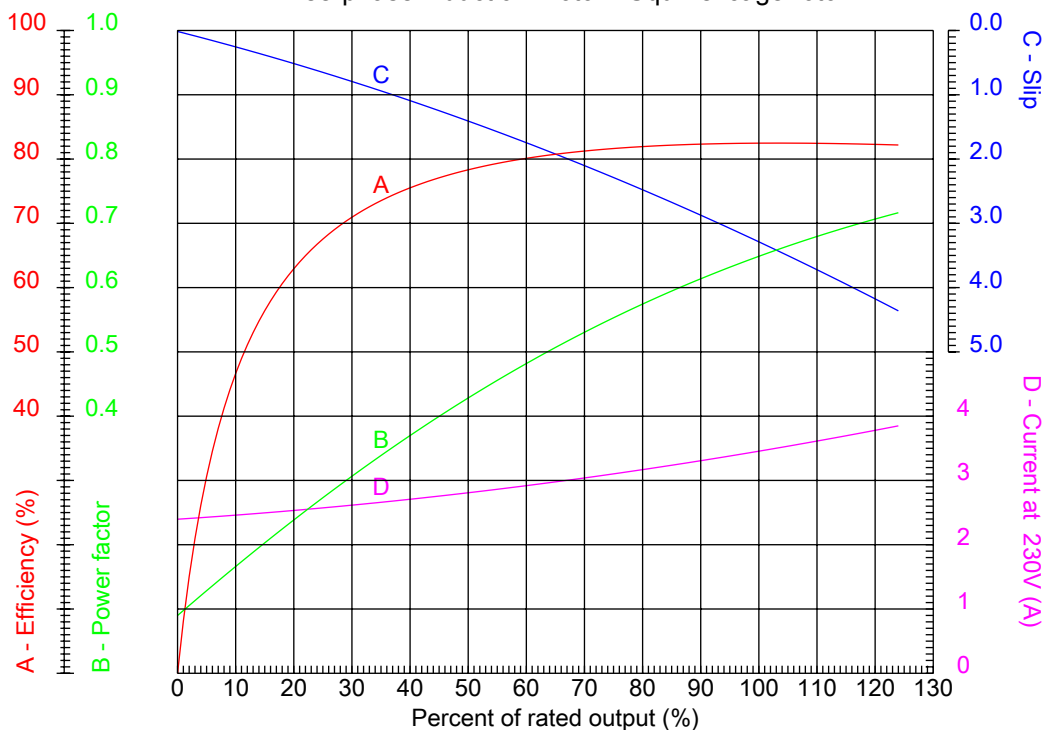

Customer :
 Product line : Three-Phase : Rolled Steel Motor - NEMA Premium Efficiency

| | | | |
|------------------|--------------------|--|-----------------------|
| Frame | : 143/5T | Locked rotor current (I _l /I _n) | : 5.7 |
| Output | : 1 HP | Duty cycle | : S1 |
| Frequency | : 60 Hz | Service factor | : 1.15 (1.00 at 208V) |
| Full load speed | : 1160 rpm | Design | : B |
| Voltage | : 208-230/460 V | Locked rotor torque | : 250 % |
| Rated current | : 3.55-3.50/1.75 A | Breakdown torque | : 300 % |
| Insulation class | : F | | |

Notes:
 Downloaded from <http://dealerselectric.com>
 Generated for Model #00112ET3ERS145TC

Performed by

Checked



CHARACTERISTIC CURVES RELATED TO SPEED

Three-phase induction motor - Squirrel cage rotor

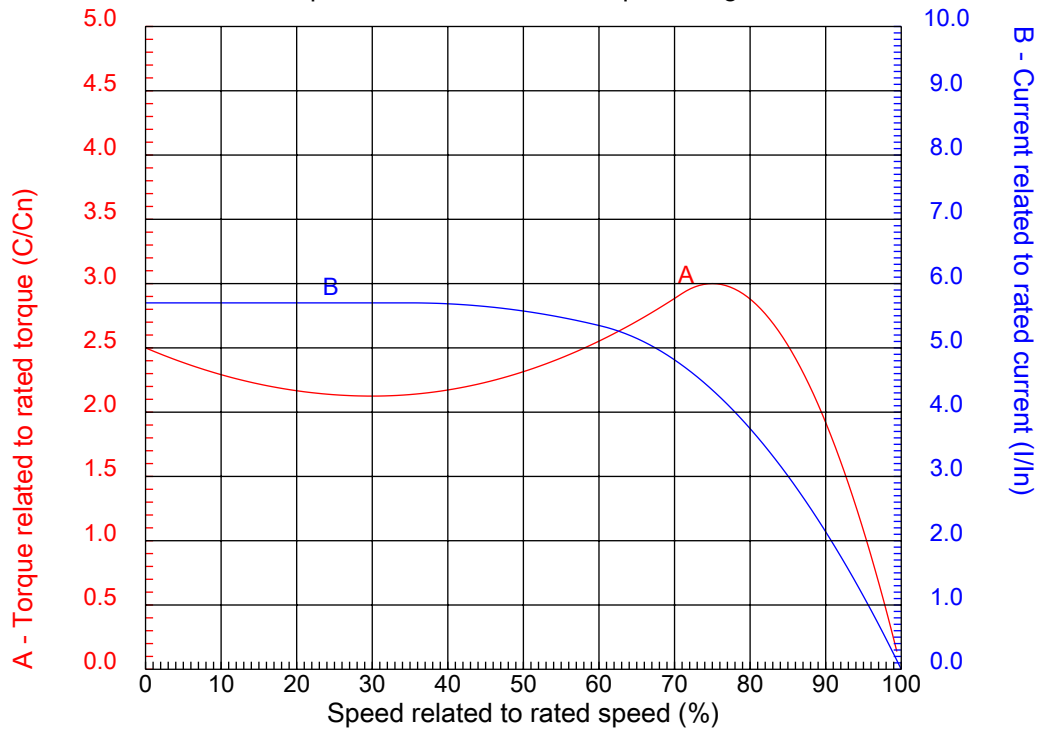

Customer :
Product line : Three-Phase : Rolled Steel Motor - NEMA Premium Efficiency

| | | | |
|------------------|--------------------|--|-----------------------|
| Frame | : 143/5T | Locked rotor current (I _l /I _n) | : 5.7 |
| Output | : 1 HP | Duty cycle | : S1 |
| Frequency | : 60 Hz | Service factor | : 1.15 (1.00 at 208V) |
| Full load speed | : 1160 rpm | Design | : B |
| Voltage | : 208-230/460 V | Locked rotor torque | : 250 % |
| Rated current | : 3.55-3.50/1.75 A | Breakdown torque | : 300 % |
| Insulation class | : F | | |

Notes:
Downloaded from <http://dealerselectric.com>
Generated for Model #00112ET3ERS145TC

Performed by

Checked

1 2 3 4 5 6 7 8

A
B
C
D
E
F

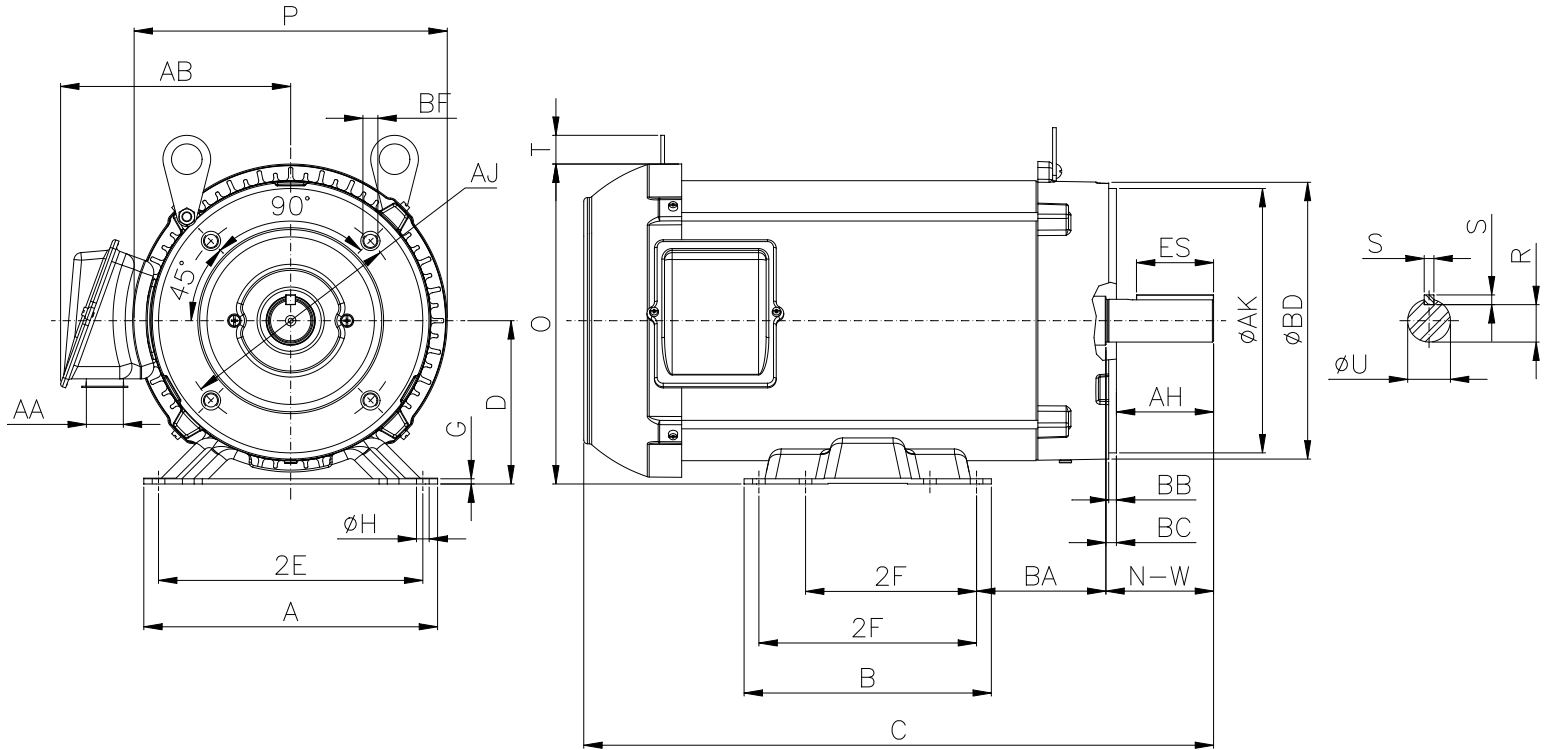

Notes: Downloaded from <http://dealerselectric.com>
Generated for Model #00112ET3ERS145TC

Performed by:

Checked:

Customer:

Three-Phase : Rolled Steel Motor - NEMA Premium Efficiency

| | | | | |
|-------------|-------------------|------------------|----------------|-------------------|
| 2E 5.500 | J 1.732 | A 6.535 | P 7.323 | 2F 4.000/5.000 |
| K 2.25 | B 6.496 | BA 2.750 | U 0.8750 | N-W 2.250 |
| ES 1.417 | S 0.187 | R 0.766 | depth 0.187 | D 3.500 |
| O 7.165 | T 0.237 | H 0.343 | C 14.095 | FC 7.874 |
| d1 A 4 | d2 DM6 | Flange FC-149 | AJ 5.875 | AK 4.500 |
| BD 6.535 | BF UNC 3/8"x16 | BB 0.157 | BC 9 | |

Three-phase induction motor
Frame 143/5T - IP55

12-SEP-2016



1 2 3 4 5 6 7 8

A

LOW VOLTAGE

HIGH VOLTAGE

B

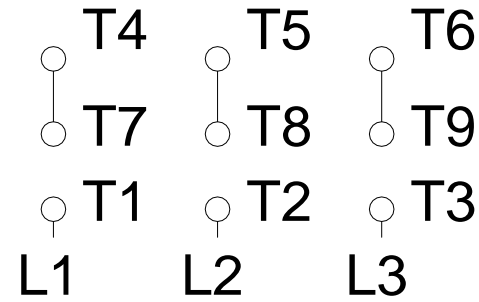
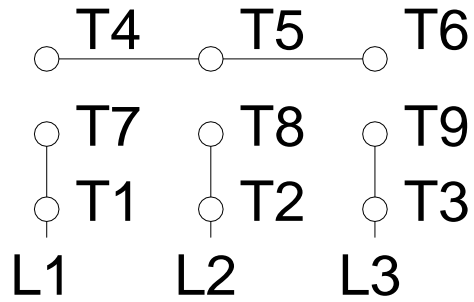

C

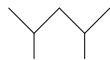

D

E

F

Notes: Downloaded from <http://dealerselectric.com>
 Generated for Model #00112ET3ERS145TC

Performed by:

Checked:

Customer:

Three-Phase : Rolled Steel Motor - NEMA Premium Efficiency

Three-phase induction motor
 Frame 143/5T - IP55

12-SEP-2016

