

TYPE	OUTPUT		POLE	TIME RATING	VOLTAGE V	Hz	SYN.SPEED R.P.M
	HP.	KW.					
AEHH8NCF	150	111.9	6	CONT.	460	60	1200

TOTALLY ENCLOSED FAN-COOLED TYPE. SQUIRREL-CAGE ROTOR

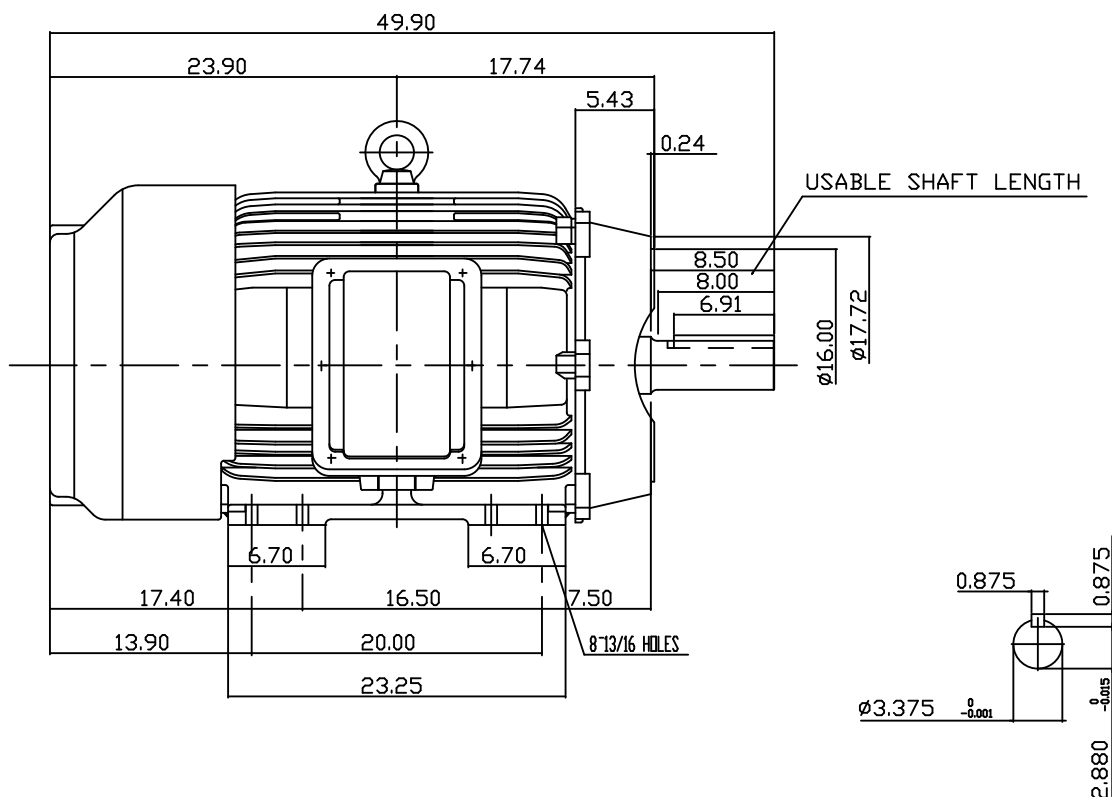

NOTE:

1. DIMENSIONS IN INCH
2. FRAME NO. 447TC
3. F CLASS INSULATION, S.F.1.15
4. FOR DIRECT FLEXIBLE COUPLING
5. ENCLOSURE: IP54
6. BEARING SIZE: DRIVE END: 6320  
NON-DRIVE END: 6316
7. APPROX. WEIGHT: 2450 LBS

TW-56C

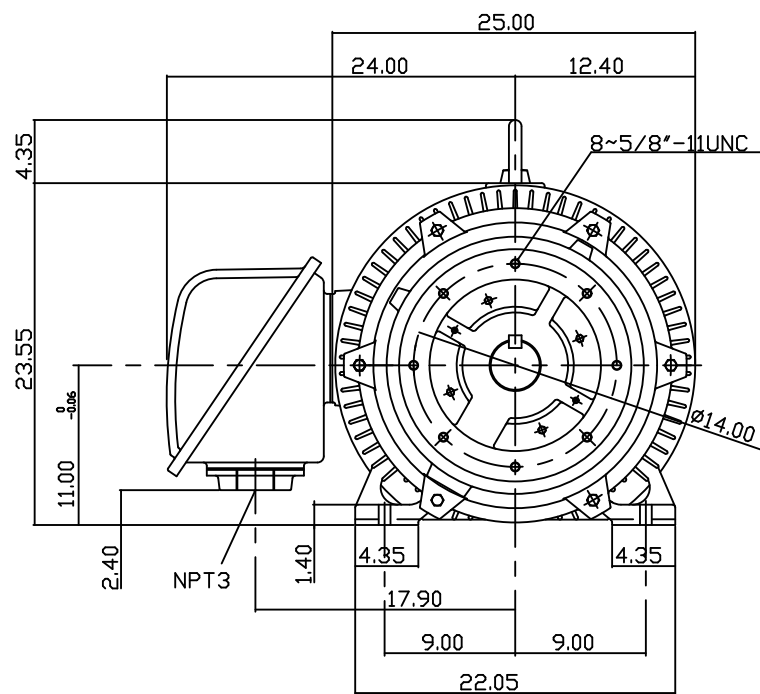

DATE Sept. 25, 2012		OUTLINE DIMENSIONS	
CAT #:		3-PHASE INDUCTION MOTOR	
DWN. Y.ZHU		DWG NO.	
CHKD. H.HUANG		REV: 00	
APPD. C.WANG		3B040C731	

TEC Westinghouse