

DATA SHEET



Three Phase Induction Motor - Squirrel Cage

Customer : Dealers Industrial Equipment 800-469-3110		Customer reference : 02512OT3E324TC-W40			
Product line : W40 NEMA Premium Efficiency Three-Phase		Product code : 14786494	Catalog # : 02512OT3E324TC-W40		
Frame : 324TC Output : 25 HP (18.5 kW) Poles : 6 Frequency : 60 Hz Rated voltage : 208-230/460 V Rated current : 68.1-61.6/30.8 A L. R. Amperes : 422-382/191 A LRC : 6.2x(Code G) No load current : 24.5-28.4/14.2 A Rated speed : 1183 rpm Slip : 1.42 % Rated torque : 109 ft.lb Locked rotor torque : 210 % Breakdown torque : 250 % Insulation class : F Service factor : 1.25 Moment of inertia (J) : 7.69 sq.ft.lb Design : B	Locked rotor time : 32s (cold) 18s (hot) Temperature rise : 80 K Duty cycle : Cont.(S1) Ambient temperature : -20°C to +40°C Altitude : 1000 m.a.s.l. Protection degree : IP23 Cooling method : IC01 - ODP Mounting : F-1 Rotation ¹ : Both (CW and CCW) Noise level ² : 62.0 dB(A) Starting method : Direct On Line Approx. weight ³ : 474 lb				
Output	50%	75%	100%		
Efficiency (%)	91.7	92.4	93.0		
Power Factor	0.65	0.76	0.81		
Foundation loads					
Max. traction					
Max. compression					
		<u>Drive end</u>	<u>Non drive end</u>		
Bearing type	:	6312 Z C3	6211 Z C3		
Sealing	:	Without Bearing Seal	Without Bearing Seal		
Lubrication interval	:	20000 h	20000 h		
Lubricant amount	:	21 g	11 g		
Lubricant type	:	Mobil Polyrex EM			
Notes downloaded from http://dealerselectric.com					
This revision replaces and cancel the previous one, which must be eliminated. (1) Looking the motor from the shaft end. (2) Measured at 1m and with tolerance of +3dB(A). (3) Approximate weight subject to changes after manufacturing process. (4) At 100% of full load.		These are average values based on tests with sinusoidal power supply, subject to the tolerances stipulated in NEMA MG-1.			
Rev.	Changes Summary		Performed	Checked	Date
Performed by					
Checked by				Page	Revision
Date	22/04/2019			1 / 2	

LOAD PERFORMANCE CURVE



Three Phase Induction Motor - Squirrel Cage

Customer : Dealers Industrial Equipment 800-469-3110
 Customer reference : 02512OT3E324TC-W40

Product line : W40 NEMA Premium Efficiency Three-Phase Product code : 14786494
 Catalog # : 02512OT3E324TC-W40

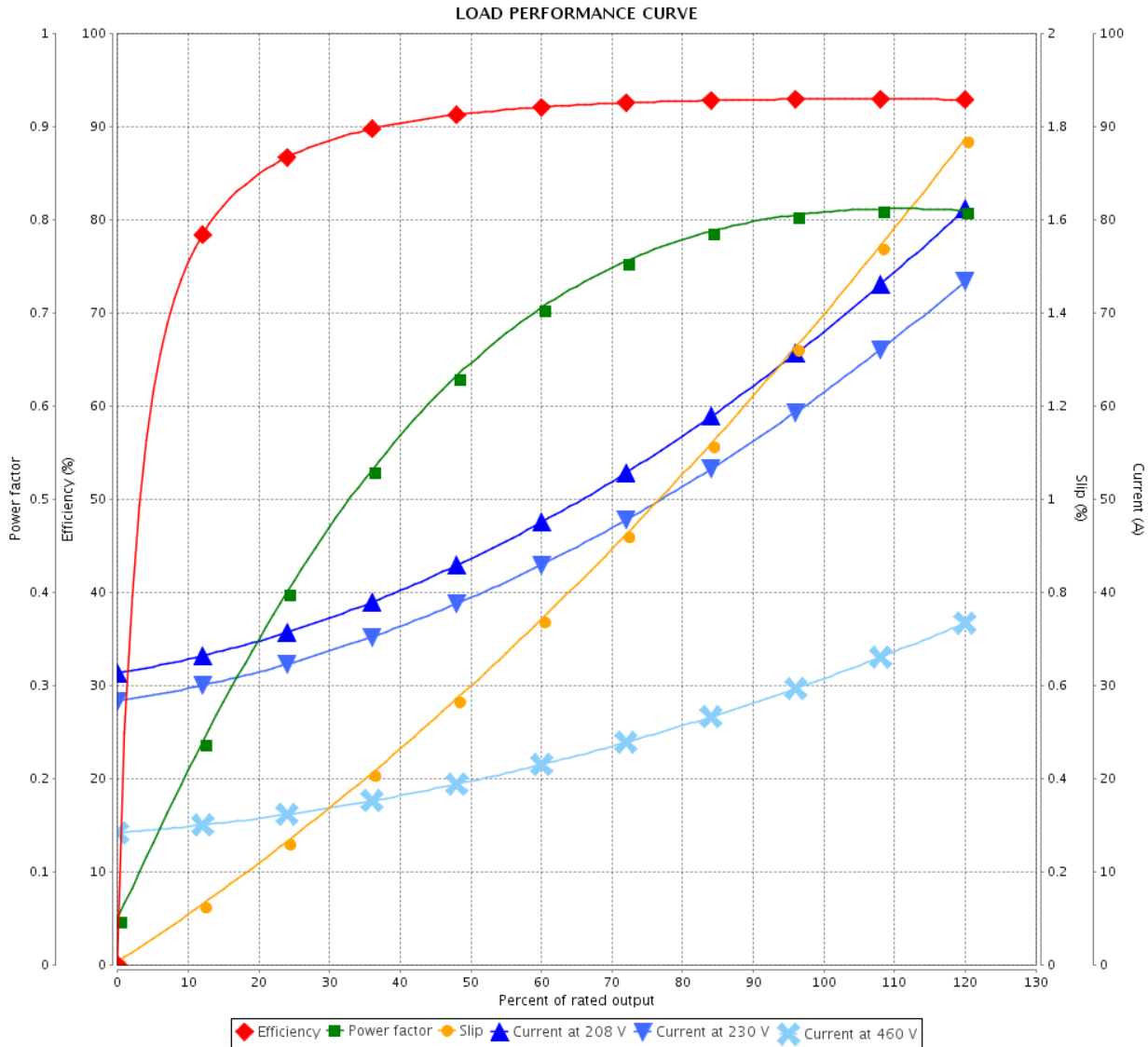

Performance : 208-230/460 V 60 Hz 6P

Rated current : 68.1-61.6/30.8 A	Moment of inertia (J) : 7.69 sq.ft.lb
LRC : 6.2	Duty cycle : Cont.(S1)
Rated torque : 109 ft.lb	Insulation class : F
Locked rotor torque : 210 %	Service factor : 1.25
Breakdown torque : 250 %	Temperature rise : 80 K
Rated speed : 1183 rpm	Design : B

Rev.	Changes Summary	Performed	Checked	Date
Performed by			Page 2 / 2	Revision
Checked by				
Date	22/04/2019			

Dimensões em polegada
Dimensions in inches

THIS IS AN UPDATED REVISION, THE
PREVIOUS ONE MUST BE DISREGARDED.

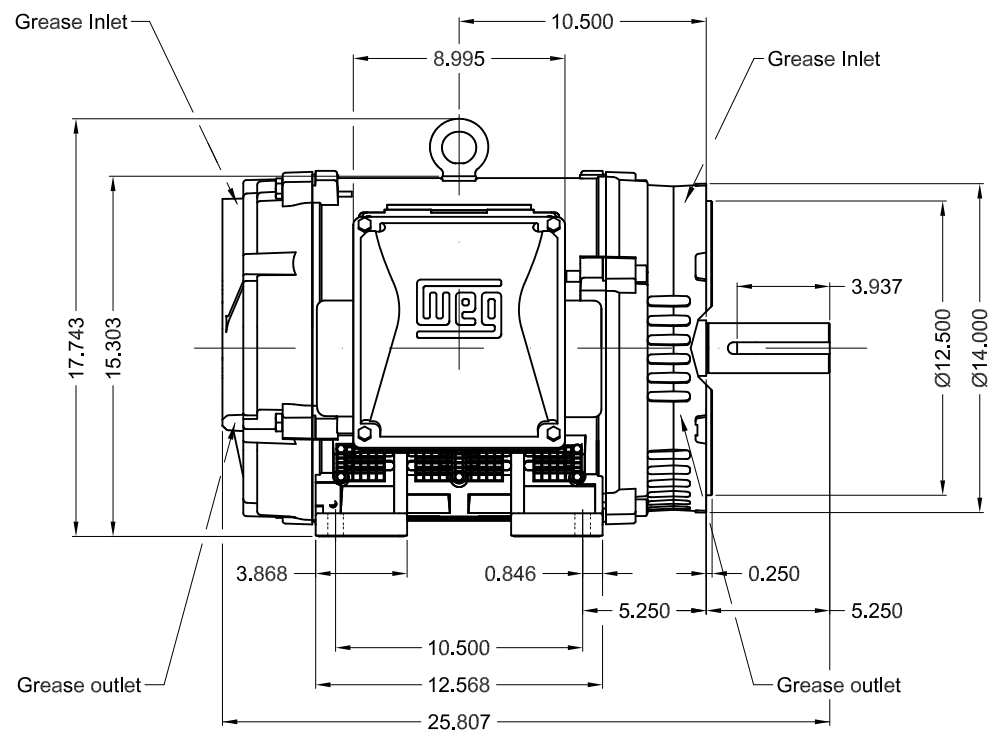
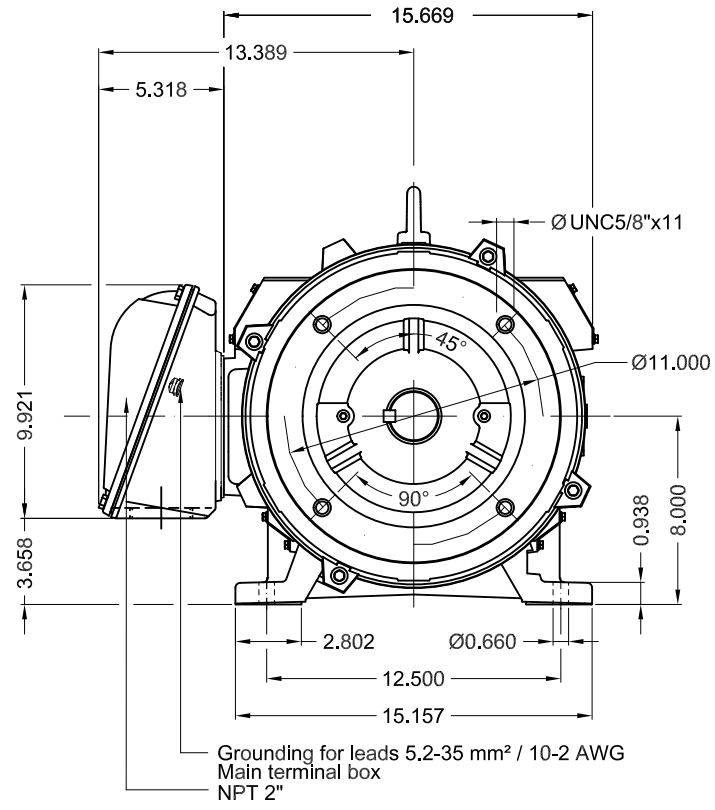

Color RAL 5009
Painting plan 203A
Mounting B34R(D)

					SCALE	1:8	
ECM	LOC	SUMMARY OF MODIFICATIONS	EXECUTED	CHECKED	RELEASED	DATE	VER
EXECUTED	USERADMIN	THREE PHASE W40 MOTOR NEMA PREMIUM EFF					
CHECKED		FRAME 324TC IP23 ODP					
RELEASED		WEG code: 14786494					
REL DT	22.04.2019	WMO Jaragua do Sul	Product Engineering	SHEET	1 / 1		

25 HP 06 Poles 60Hz

A

