



# LOAD PERFORMANCE CURVE



## Three Phase Induction Motor - Squirrel Cage

Customer : Dealers Industrial Equipment 800-469-3110  
 Customer reference : 04018OT3H324TC-W40

Product line : W40 NEMA Premium Efficiency Three-Phase      Product code : 14496910  
 Catalog # : 04018OT3H324TC-W40

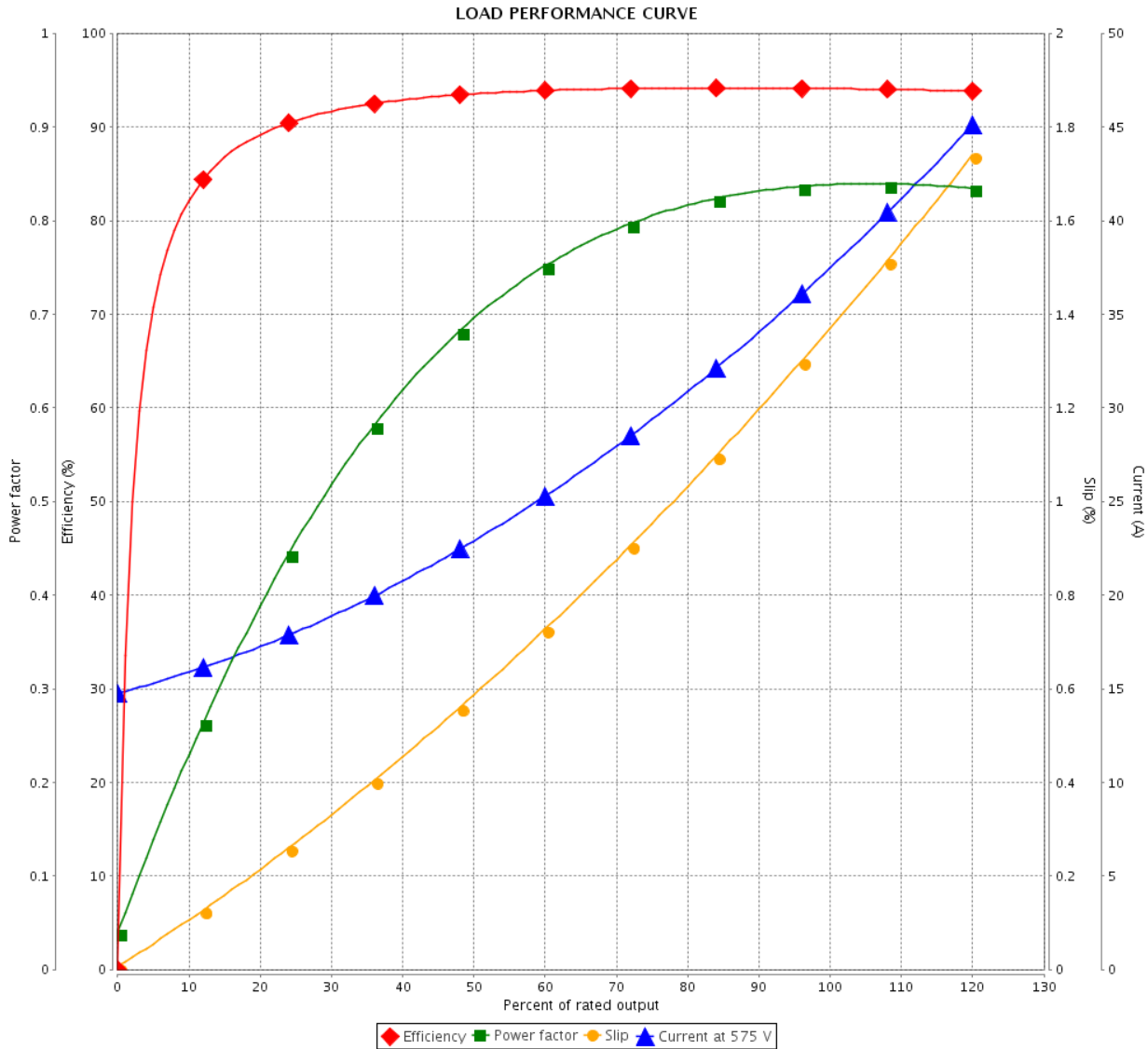

Performance : 575 V 60 Hz 4P

Rated current : 38.1 A	Moment of inertia (J) : 5.69 sq.ft.lb
LRC : 6.2	Duty cycle : Cont.(S1)
Rated torque : 117 ft.lb	Insulation class : F
Locked rotor torque : 200 %	Service factor : 1.25
Breakdown torque : 240 %	Temperature rise : 80 K
Rated speed : 1775 rpm	Design : B

Rev.	Changes Summary	Performed	Checked	Date
Performed by			Page	Revision
Checked by				
Date				
			2 / 2	

Dimensões em polegada  
Dimensions in inches

THIS IS AN UPDATED REVISION, THE  
PREVIOUS ONE MUST BE DISREGARDED.

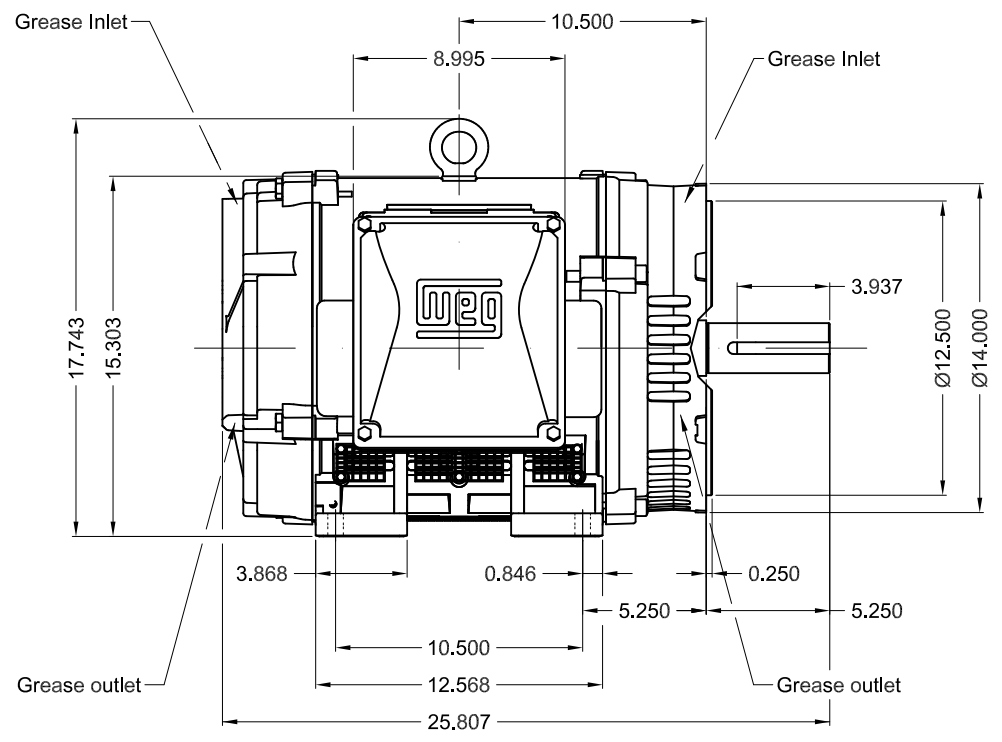
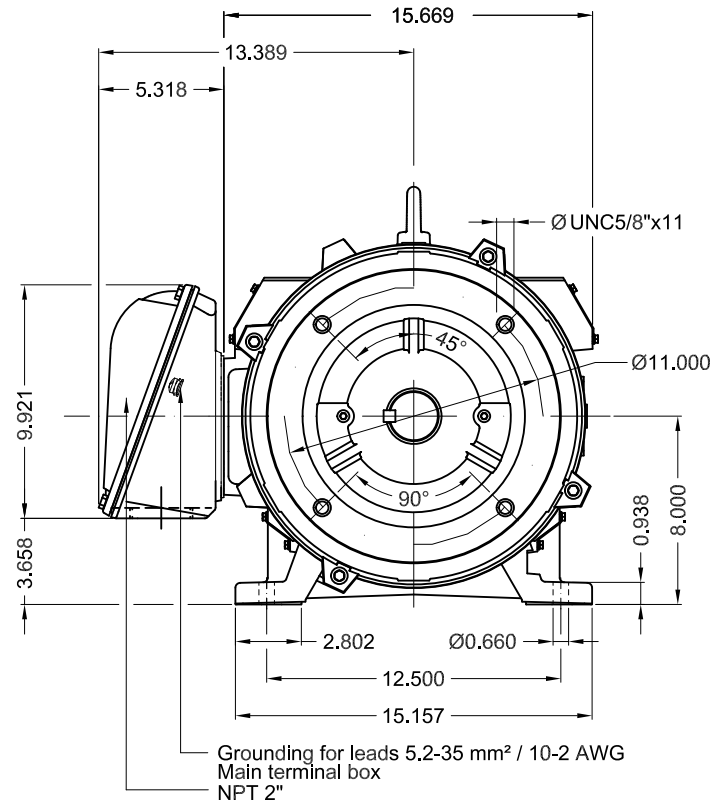

Color RAL 5009									
Painting plan 203A									
Mounting B34R(D)									
					SCALE	1:8			
ECM	LOC	SUMMARY OF MODIFICATIONS			EXECUTED	CHECKED	RELEASED	DATE	VER
EXECUTED	USERADMIN	THREE PHASE W40 MOTOR NEMA PREMIUM EFF							
CHECKED		FRAME 324TC IP23 ODP							
RELEASED		WEG code: 14496910							
REL DT	14.04.2019	WMO	Jaragua do Sul	Product Engineering	SHEET	1 / 1			

40 HP 04 Poles 60Hz

A





**W40 NEMA**  
**CC029A Premium**

*Inverter Duty Motor*



3PT9  
**LISTED**

IEC 60034-1



**Energy Verified**

For use on PWM, VT 1000:1, CT 3:1, 1.0SF

MODEL 040180T3H324TC-W40  
 MADE IN BRAZIL  
 14496910

PH 3	FR 324TC	HP(kW) 40(30)		Hz 60
V 575		A 38.1		IP23
NEMA NOM EFF		94.1	%	RPM 1775
ENCL ODP	DUTY	CONT.		INS. CL. F $\Delta$ T 80 K
PF 0.84		DES B	CODE G	AMB. 40°C
SF 1.25		SFA 47.6		ALT 1000 m.a.s.l.

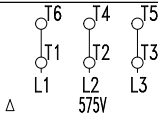

→ 6312-Z-C3  
 → 6211-Z-C3

MOBIL POLYREX EM  
 21 g 20000 h

459 Lbs