

# DATA SHEET



## Three Phase Induction Motor - Squirrel Cage

Customer	: Dealers Industrial Equipment 800-469-3110			
Customer reference	: 01012OT3H256TC-W40			
Product line	: W40 NEMA Premium Efficiency Three-Phase	Product code :	14494125	
		Catalog # :	01012OT3H256TC-W40	
Frame	: 254/6TC	Locked rotor time	: 30s (cold) 17s (hot)	
Output	: 10 HP (7.5 kW)	Temperature rise	: 80 K	
Poles	: 6	Duty cycle	: Cont.(S1)	
Frequency	: 60 Hz	Ambient temperature	: -20°C to +40°C	
Rated voltage	: 575 V	Altitude	: 1000 m.a.s.l.	
Rated current	: 10.2 A	Protection degree	: IP23	
L. R. Amperes	: 69.6 A	Cooling method	: IC01 - ODP	
LRC	: 6.8x(Code H)	Mounting	: F-1	
No load current	: 4.88 A	Rotation <sup>1</sup>	: Both (CW and CCW)	
Rated speed	: 1180 rpm	Noise level <sup>2</sup>	: 59.0 dB(A)	
Slip	: 1.67 %	Starting method	: Direct On Line	
Rated torque	: 43.9 ft.lb	Approx. weight <sup>3</sup>	: 300 lb	
Locked rotor torque	: 229 %			
Breakdown torque	: 300 %			
Insulation class	: F			
Service factor	: 1.25			
Moment of inertia (J)	: 3.53 sq.ft.lb			
Design	: B			
Output	25% 50% 75% 100%	Foundation loads		
Efficiency (%)	89.4 90.2 91.0 91.7	Max. traction		
Power Factor	0.37 0.62 0.74 0.80	Max. compression		
		<u>Drive end</u>	<u>Non drive end</u>	
Bearing type	:	6309 Z C3	6209 Z C3	
Sealing	:	Without Bearing Seal	Without Bearing Seal	
Lubrication interval	:	20000 h	20000 h	
Lubricant amount	:	13 g	9 g	
Lubricant type	:	Mobil Polyrex EM		
Notes downloaded from <a href="http://dealerselectric.com">http://dealerselectric.com</a>				
This revision replaces and cancel the previous one, which must be eliminated. (1) Looking the motor from the shaft end. (2) Measured at 1m and with tolerance of +3dB(A). (3) Approximate weight subject to changes after manufacturing process. (4) At 100% of full load.		These are average values based on tests with sinusoidal power supply, subject to the tolerances stipulated in NEMA MG-1.		
Rev.	Changes Summary	Performed	Checked	Date
Performed by				
Checked by			Page	Revision
Date	13/04/2019		1 / 2	

# LOAD PERFORMANCE CURVE



## Three Phase Induction Motor - Squirrel Cage

Customer : Dealers Industrial Equipment 800-469-3110  
 Customer reference : 01012OT3H256TC-W40

Product line : W40 NEMA Premium Efficiency Three-Phase      Product code : 14494125  
 Catalog # : 01012OT3H256TC-W40

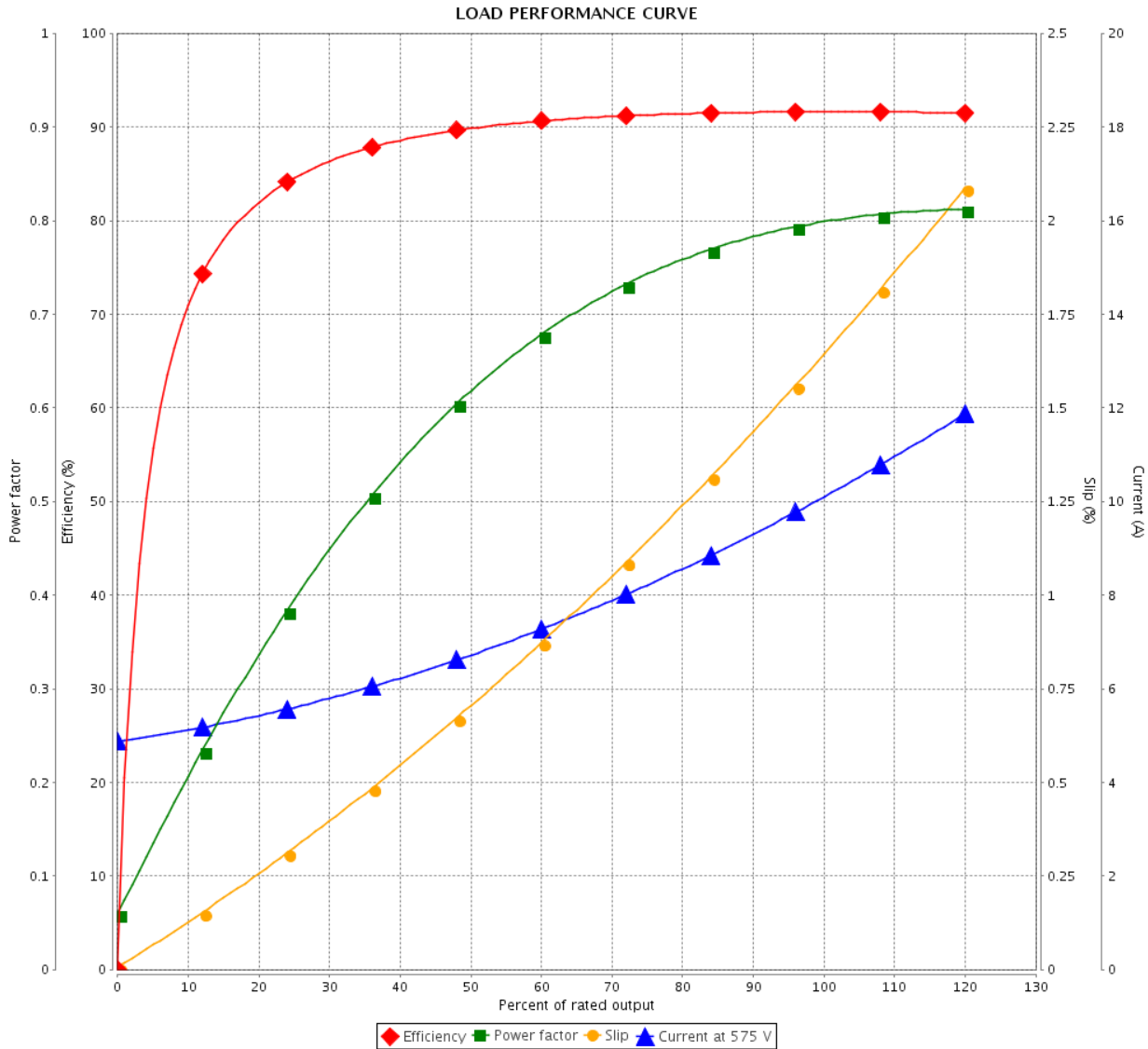

Performance : 575 V 60 Hz 6P

Rated current : 10.2 A	Moment of inertia (J) : 3.53 sq.ft.lb
LRC : 6.8	Duty cycle : Cont.(S1)
Rated torque : 43.9 ft.lb	Insulation class : F
Locked rotor torque : 229 %	Service factor : 1.25
Breakdown torque : 300 %	Temperature rise : 80 K
Rated speed : 1180 rpm	Design : B

Rev.	Changes Summary	Performed	Checked	Date
Performed by			Page	Revision
Checked by			2 / 2	
Date	13/04/2019			

Dimensões em polegada  
Dimensions in inches

THIS IS AN UPDATED REVISION, THE  
PREVIOUS ONE MUST BE DISREGARDED.

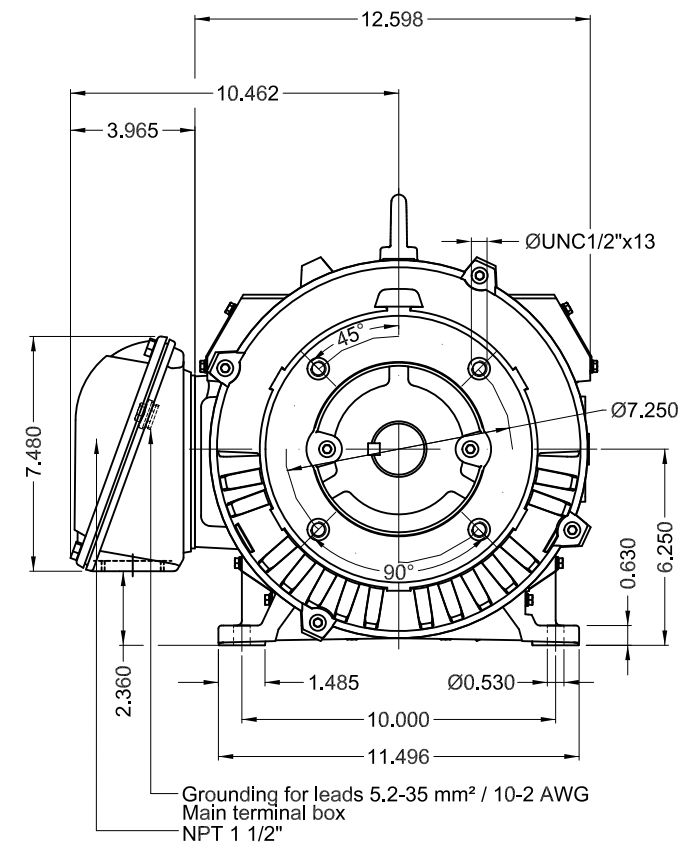

Grounding for leads 5.2-35 mm<sup>2</sup> / 10-2 AWG  
Main terminal box  
NPT 1 1/2"

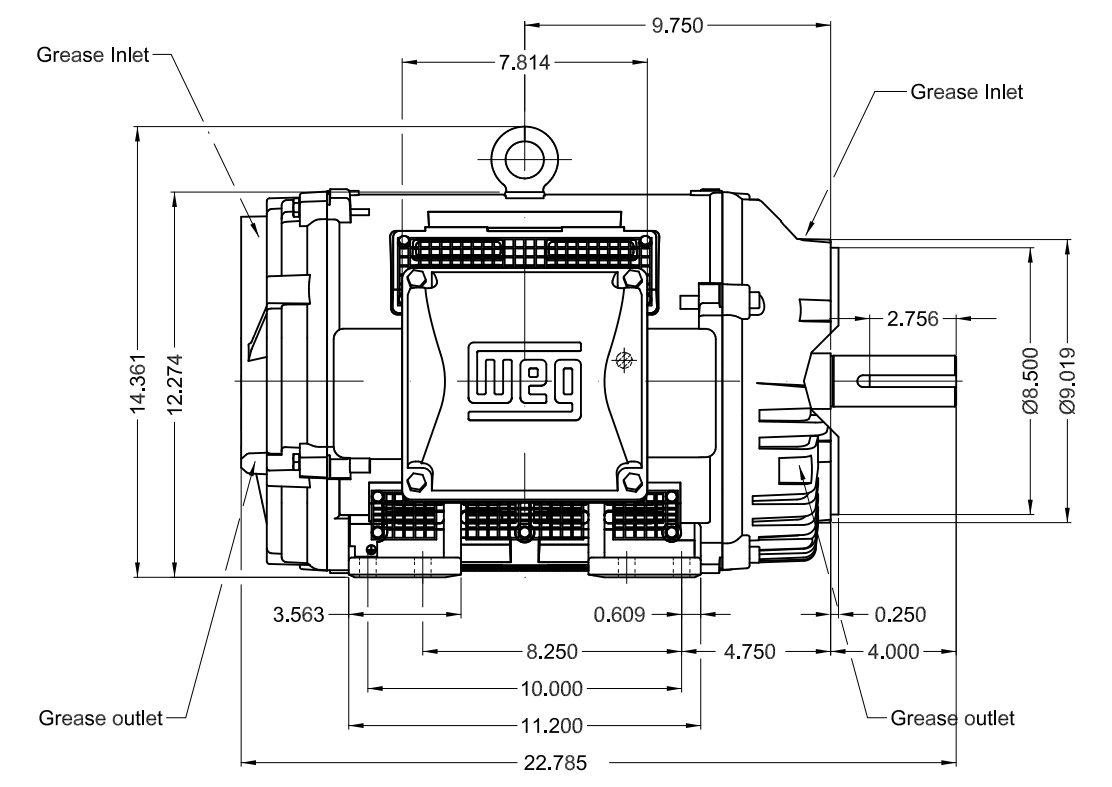

Bearing cap									
Color RAL 5009									
Painting plan 203A									
Mounting B34R(D)									
					SCALE	1:6			
ECM	LOC	SUMMARY OF MODIFICATIONS			EXECUTED	CHECKED	RELEASED	DATE	VER
EXECUTED	USERADMIN	THREE PHASE W40 MOTOR NEMA PREMIUM EFF							
CHECKED		FRAME 254/6TC IP23 ODP							
RELEASED		WEG code: 14494125							
REL DT	13.04.2019	WMO	Jaragua do Sul	Product Engineering	SHEET	1 / 1			

10 HP 06 Poles 60Hz

A

