

DATA SHEET



Three Phase Induction Motor - Squirrel Cage

Customer : Dealers Industrial Equipment 800-469-3110
 Customer reference : 04018OP3EFP324TC-W40

Product line : W40 High Efficiency Three-Phase Product code : 14491935
 Catalog # : 04018OP3EFP324TC-W40

| | |
|---------------------------------------|---|
| Frame : 324TC | Locked rotor time : 36s (cold) 20s (hot) |
| Output : 40 HP (30 kW) | Temperature rise : 105 K |
| Poles : 4 | Duty cycle : Cont.(S1) |
| Frequency : 60 Hz | Ambient temperature : -20°C to +40°C |
| Rated voltage : 208-230/460 V | Altitude : 1000 m.a.s.l. |
| Rated current : 107-96.4/48.2 A | Protection degree : IP23 |
| L. R. Amperes : 640-578/289 A | Cooling method : IC01 - ODP |
| LRC : 6.0x(Code G) | Mounting : F-1 |
| No load current : 31.0-36.0/18.0 A | Rotation ¹ : Both (CW and CCW) |
| Rated speed : 1775 rpm | Starting method : Direct On Line |
| Slip : 1.39 % | Approx. weight ³ : 459 lb |
| Rated torque : 117 ft.lb | |
| Locked rotor torque : 180 % | |
| Breakdown torque : 210 % | |
| Insulation class : F | |
| Service factor : 1.15 | |
| Moment of inertia (J) : 5.37 sq.ft.lb | |
| Design : B | |

| | | | | | |
|----------------|------|------|------|------|------------------|
| Output | 25% | 50% | 75% | 100% | Foundation loads |
| Efficiency (%) | 92.2 | 92.4 | 93.0 | 93.0 | Max. traction |
| Power Factor | 0.46 | 0.72 | 0.81 | 0.84 | Max. compression |

| | | |
|------------------------|----------------------|----------------------|
| | <u>Drive end</u> | <u>Non drive end</u> |
| Bearing type : | 6312 Z C3 | 6211 Z C3 |
| Sealing : | Without Bearing Seal | Without Bearing Seal |
| Lubrication interval : | 20000 h | 20000 h |
| Lubricant amount : | 21 g | 11 g |
| Lubricant type : | Mobil Polyrex EM | |

Notes
 downloaded from <http://dealerselectric.com>

This revision replaces and cancel the previous one, which must be eliminated.
 (1) Looking the motor from the shaft end.
 (2) Measured at 1m and with tolerance of +3dB(A).
 (3) Approximate weight subject to changes after manufacturing process.
 (4) At 100% of full load.

These are average values based on tests with sinusoidal power supply, subject to the tolerances stipulated in NEMA MG-1.

| Rev. | Changes Summary | Performed | Checked | Date |
|--------------|-----------------|-----------|---------------|----------|
| | | | | |
| Performed by | | | Page 1 / 2 | Revision |
| Checked by | | | | |
| Date | 14/04/2019 | | | |

LOAD PERFORMANCE CURVE



Three Phase Induction Motor - Squirrel Cage

Customer : Dealers Industrial Equipment 800-469-3110
 Customer reference : 04018OP3EFP324TC-W40

Product line : W40 High Efficiency Three-Phase Product code : 14491935
 Catalog # : 04018OP3EFP324TC-W40

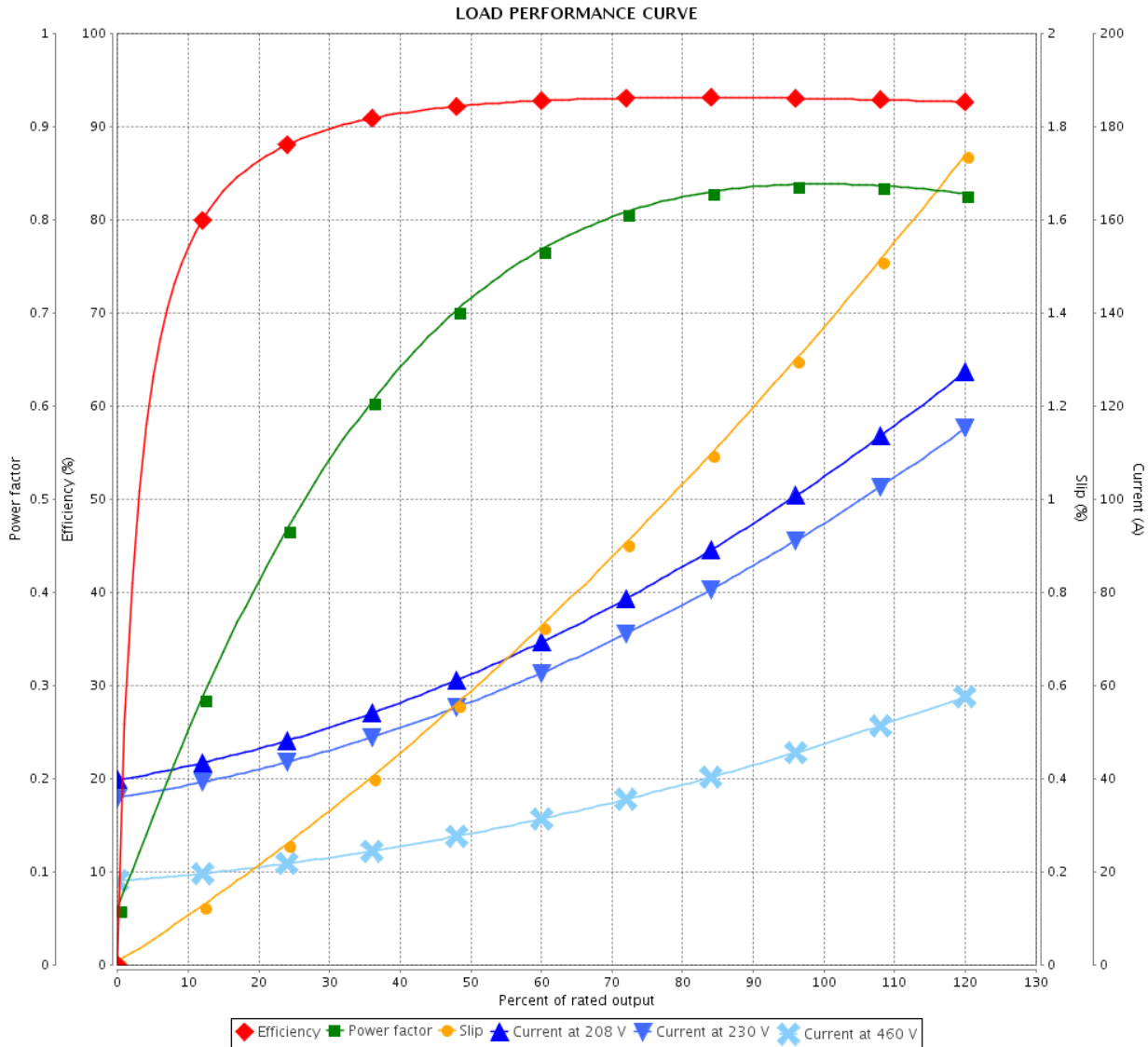

Performance : 208-230/460 V 60 Hz 4P

| | |
|---------------------------------|---------------------------------------|
| Rated current : 107-96.4/48.2 A | Moment of inertia (J) : 5.37 sq.ft.lb |
| LRC : 6.0 | Duty cycle : Cont.(S1) |
| Rated torque : 117 ft.lb | Insulation class : F |
| Locked rotor torque : 180 % | Service factor : 1.15 |
| Breakdown torque : 210 % | Temperature rise : 105 K |
| Rated speed : 1775 rpm | Design : B |

| Rev. | Changes Summary | Performed | Checked | Date |
|--------------|-----------------|-----------|---------------|----------|
| | | | | |
| Performed by | | | Page 2 / 2 | Revision |
| Checked by | | | | |
| Date | 14/04/2019 | | | |

Dimensões em polegada
Dimensions in inches

THIS IS AN UPDATED REVISION, THE
PREVIOUS ONE MUST BE DISREGARDED.

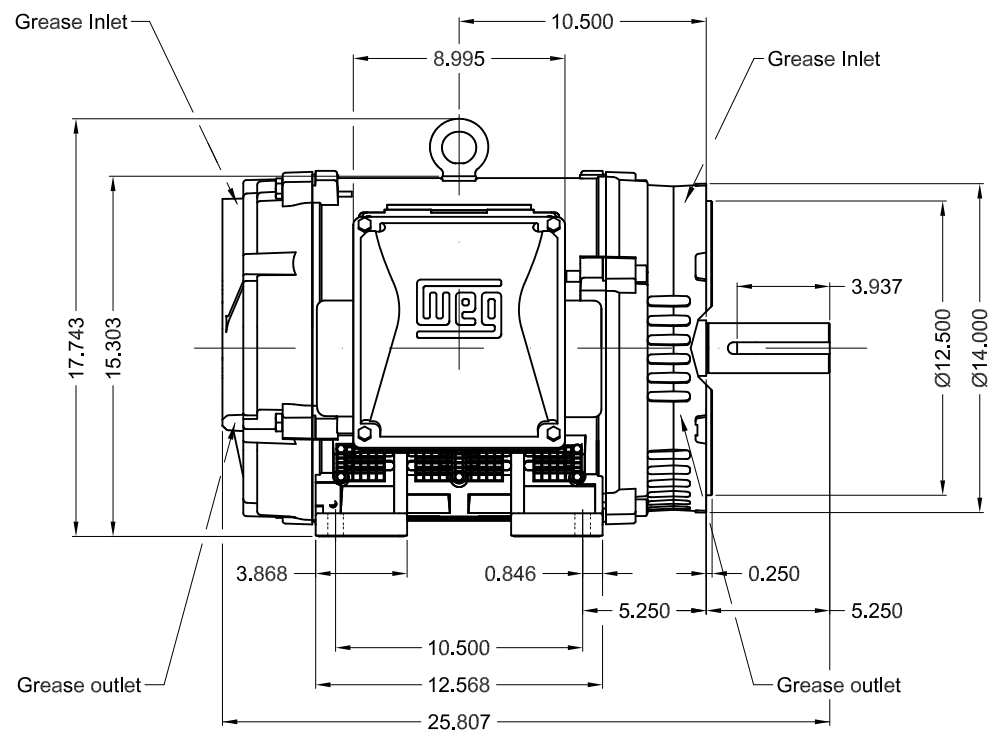
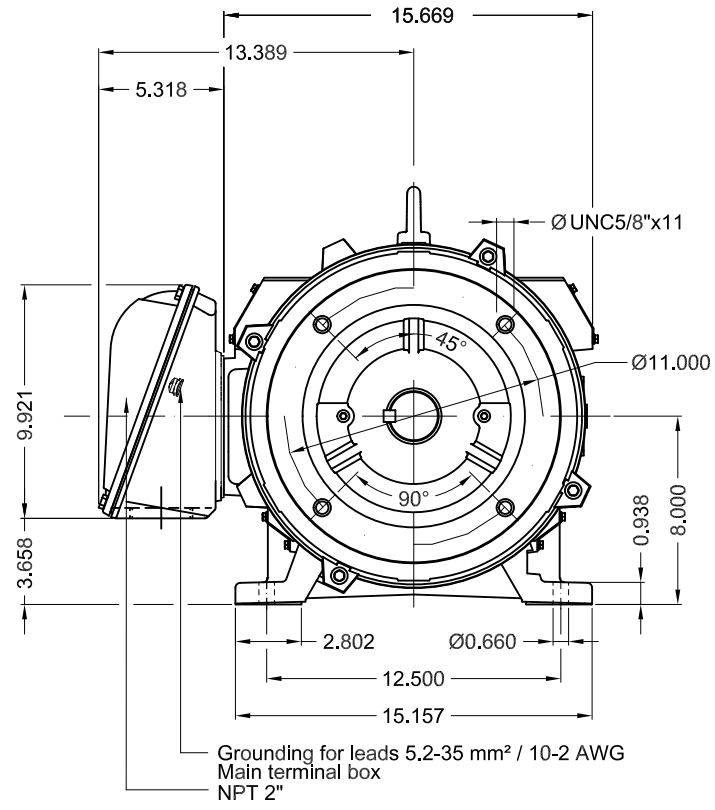

| | | | | | | | | | |
|--------------------|------------|--------------------------------|----------------|---------------------|----------|---------|----------|------|-----|
| Color RAL 3002 | | | | | | | | | |
| Painting plan 203A | | | | | | | | | |
| Mounting B34R(D) | | | | | | | | | |
| | | | | | SCALE | 1:8 | | | |
| ECM | LOC | SUMMARY OF MODIFICATIONS | | | EXECUTED | CHECKED | RELEASED | DATE | VER |
| EXECUTED | USERADMIN | THREE PHASE W40 MOTOR HIGH EFF | | | | | | | |
| CHECKED | | FRAME 324TC IP23 ODP | | | | | | | |
| RELEASED | | WEG code: 14491935 | | | | | | | |
| REL DT | 14.04.2019 | WMO | Jaragua do Sul | Product Engineering | SHEET | 1 / 1 | | | |

40 HP 04 Poles 60Hz

A

