

LOAD PERFORMANCE CURVE

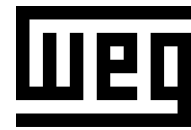

Three Phase Induction Motor - Squirrel Cage

Customer : Dealers Industrial Equipment 800-469-3110
 Customer reference : 04036OT3H286JP-W40

Product line : W40 JP Pump NEMA Premium Efficiency Three-Phase Product code : 14490081
 Catalog # : 04036OT3H286JP-W40

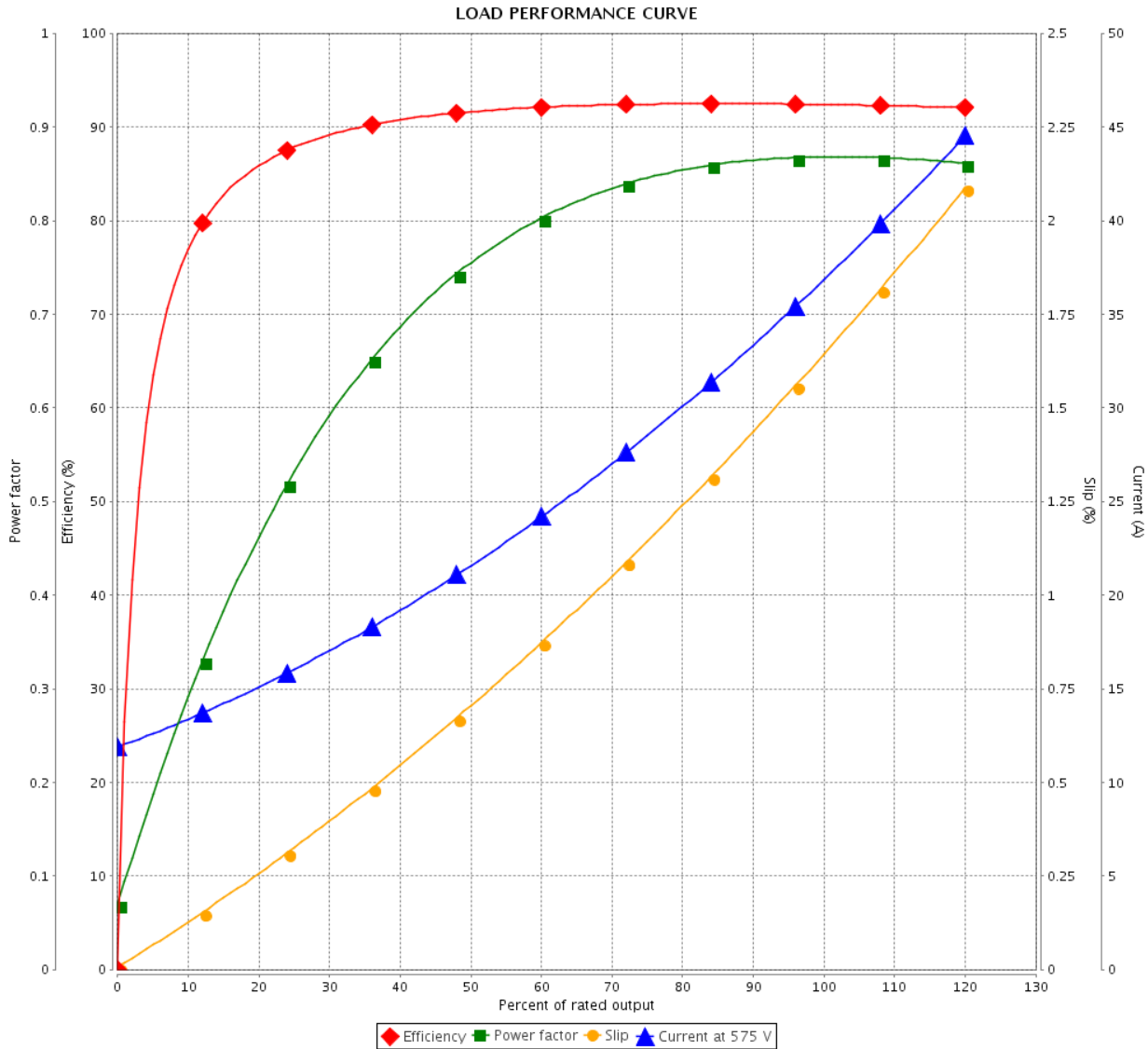

Performance : 575 V 60 Hz 2P

Rated current : 37.4 A	Moment of inertia (J) : 2.02 sq.ft.lb
LRC : 6.5	Duty cycle : Cont.(S1)
Rated torque : 58.5 ft.lb	Insulation class : F
Locked rotor torque : 190 %	Service factor : 1.25
Breakdown torque : 260 %	Temperature rise : 80 K
Rated speed : 3540 rpm	Design : B

Rev.	Changes Summary	Performed	Checked	Date
Performed by			Page 2 / 2	Revision
Checked by				
Date	14/04/2019			

Dimensões em polegada
Dimensions in inches

THIS IS AN UPDATED REVISION, THE
PREVIOUS ONE MUST BE DISREGARDED.

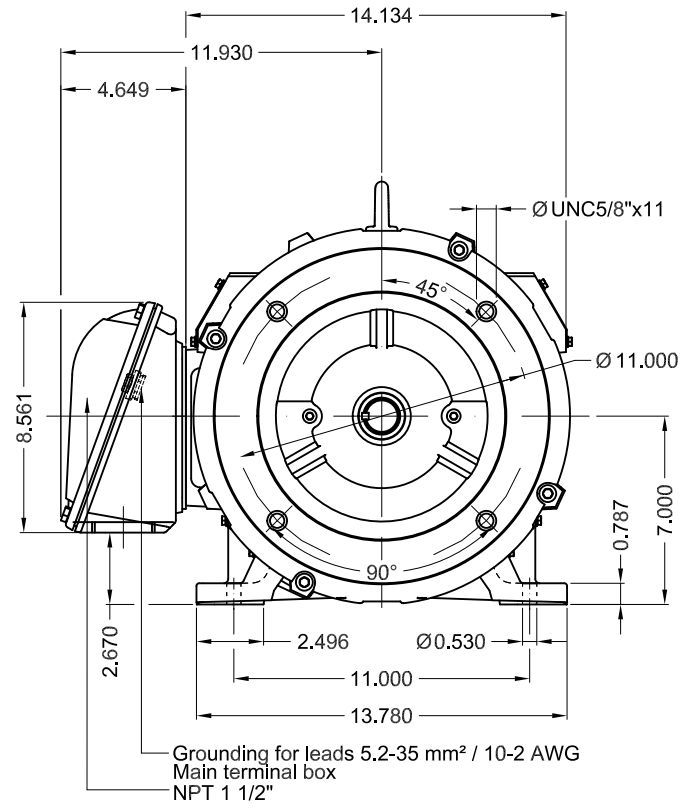

Grounding for leads 5.2-35 mm² / 10-2 AWG
Main terminal box
NPT 1 1/2"

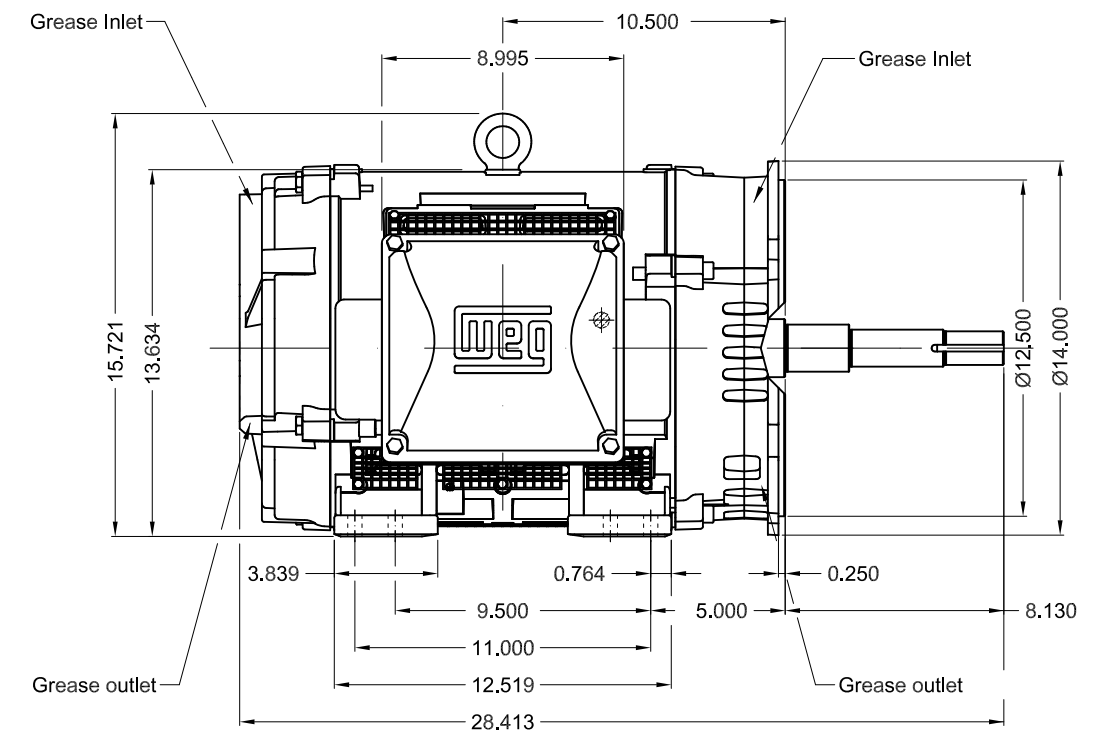

Color RAL 5009
Painting plan 203A
Mounting B34R(D)

SCALE 1:7

ECM	LOC	SUMMARY OF MODIFICATIONS			EXECUTED	CHECKED	RELEASED	DATE	VER
EXECUTED	USERADMIN		THREE PHASE W40 MOTOR NEMA PREMIUM EFF						
CHECKED			FRAME 284/6JP IP23 ODP						
RELEASED			CLOSE COUPLED PUMP JP TYPE W						
REL DT	14.04.2019	WMO	Jaragua do Sul	Product Engineering	SHEET	1 / 1			



40 HP 02 Poles 60Hz

A