

DATA SHEET



Three Phase Induction Motor - Squirrel Cage

Customer : Dealers Industrial Equipment 800-469-3110		Customer reference : 10036OT3E365TSCF2-W4			
Product line : W40 NEMA Premium Efficiency Three-Phase		Product code : 14284844	Catalog # : 10036OT3E365TSCF2-W4		
Frame : 364/5TSC	Locked rotor time : 23s (cold) 13s (hot)	Output : 100 HP (75 kW)	Temperature rise : 80 K		
Poles : 2	Duty cycle : Cont.(S1)	Frequency : 60 Hz	Ambient temperature : -20°C to +40°C		
Rated voltage : 208-230/460 V	Altitude : 1000 m.a.s.l.	Rated current : 257-232/116 A	Protection degree : IP23		
L. R. Amperes : 1693-1531/766 A	Cooling method : IC01 - ODP	LRC : 6.6x(Code G)	Mounting : F-2		
No load current : 50.9-59.0/29.5 A	Rotation ¹ : Both (CW and CCW)	Rated speed : 3555 rpm	Noise level ² : 84.0 dB(A)		
Slip : 1.25 %	Starting method : Direct On Line	Rated torque : 146 ft.lb	Approx. weight ³ : 760 lb		
Locked rotor torque : 180 %		Breakdown torque : 229 %			
Insulation class : F		Service factor : 1.25			
Moment of inertia (J) : 7.20 sq.ft.lb		Design : B			
Output	25%	50%	75%	100%	Foundation loads
Efficiency (%)	92.2	92.4	93.6	93.6	Max. traction : 1075 lb
Power Factor	0.55	0.77	0.84	0.87	Max. compression : 1836 lb
Bearing type	:	<u>Drive end</u> 6314 C3	<u>Non drive end</u> 6212 Z C3		
Sealing	:	Without Bearing Seal	Without Bearing Seal		
Lubrication interval	:	14418 h	20000 h		
Lubricant amount	:	27 g	13 g		
Lubricant type	:	Mobil Polyrex EM			
Notes downloaded from http://dealerselectric.com					
This revision replaces and cancel the previous one, which must be eliminated. (1) Looking the motor from the shaft end. (2) Measured at 1m and with tolerance of +3dB(A). (3) Approximate weight subject to changes after manufacturing process. (4) At 100% of full load.			These are average values based on tests with sinusoidal power supply, subject to the tolerances stipulated in NEMA MG-1.		
Rev.	Changes Summary		Performed	Checked	Date
Performed by					
Checked by				Page	Revision
Date	15/04/2019			1 / 2	

LOAD PERFORMANCE CURVE



Three Phase Induction Motor - Squirrel Cage

Customer : Dealers Industrial Equipment 800-469-3110
 Customer reference : 10036OT3E365TSCF2-W4

Product line : W40 NEMA Premium Efficiency Three-Phase

Product code : 14284844

Catalog # : 10036OT3E365TSCF2-W4

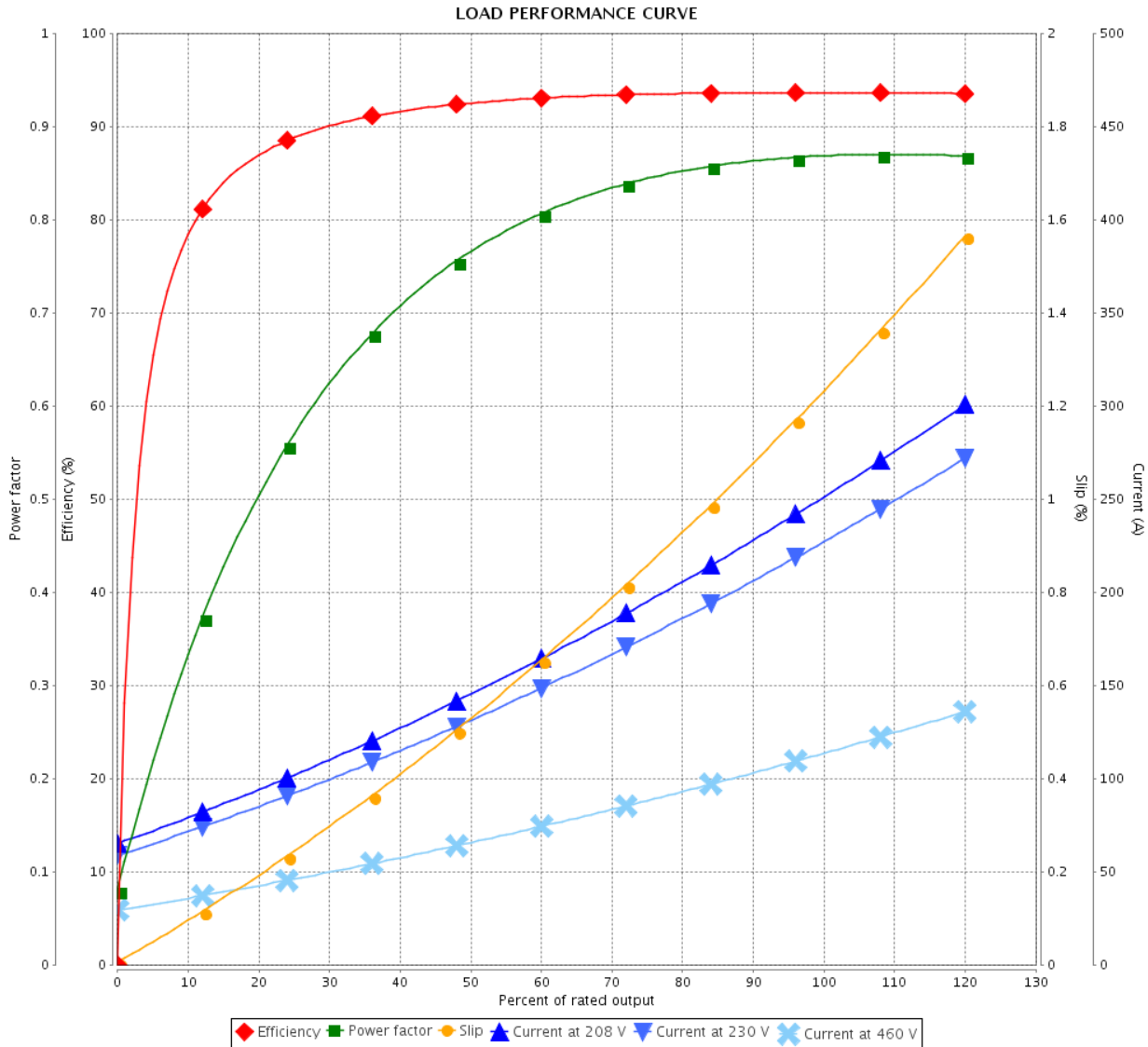

Performance : 208-230/460 V 60 Hz 2P

Rated current : 257-232/116 A
 LRC : 6.6
 Rated torque : 146 ft.lb
 Locked rotor torque : 180 %
 Breakdown torque : 229 %
 Rated speed : 3555 rpm

Moment of inertia (J) : 7.20 sq.ft.lb
 Duty cycle : Cont.(S1)
 Insulation class : F
 Service factor : 1.25
 Temperature rise : 80 K
 Design : B

Rev.	Changes Summary	Performed	Checked	Date
Performed by			Page 2 / 2	Revision
Checked by				
Date	15/04/2019			

Dimensões em polegada
Dimensions in inches

THIS IS AN UPDATED REVISION, THE
PREVIOUS ONE MUST BE DISREGARDED.

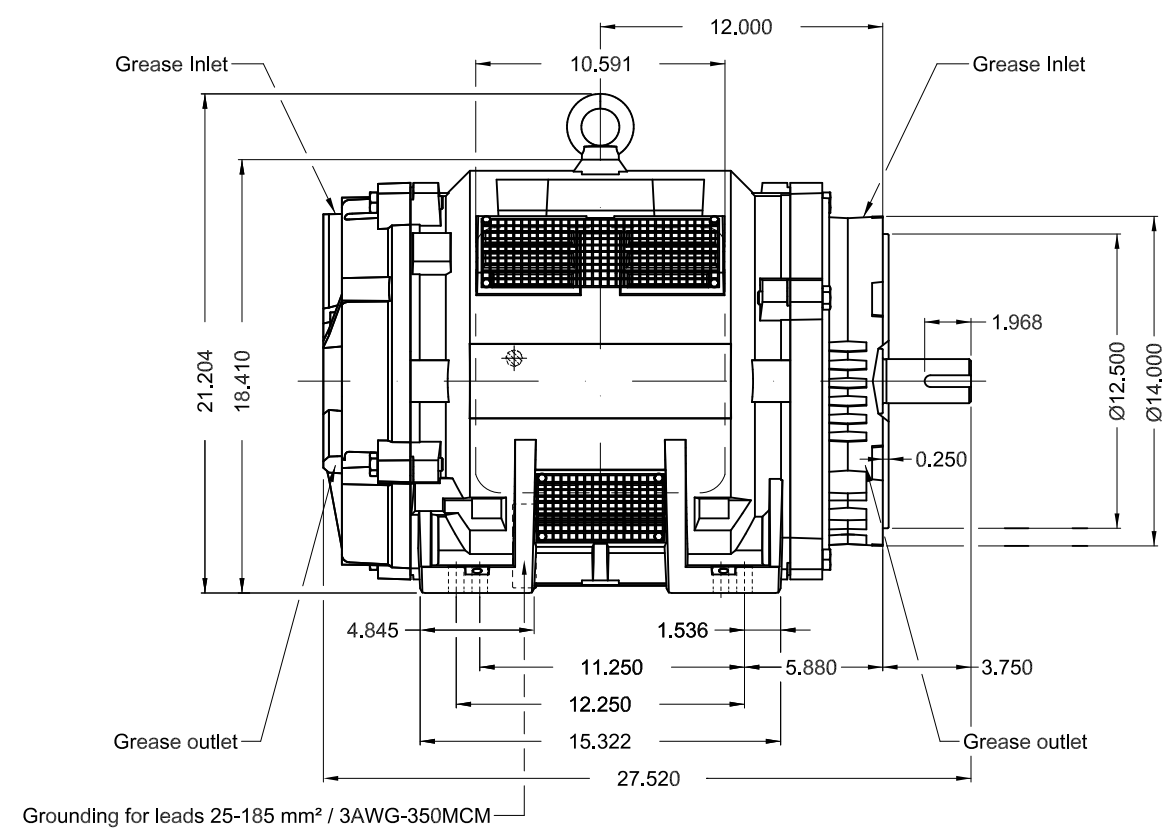
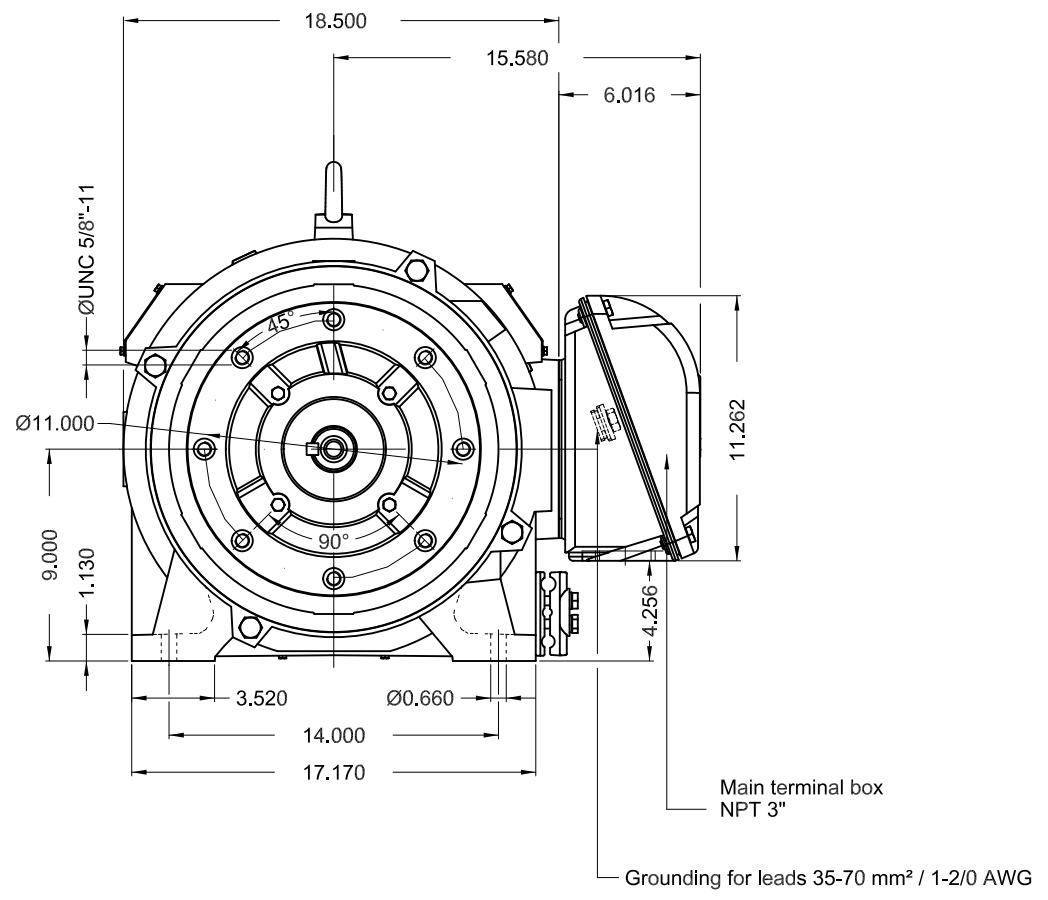

Color RAL 5009
Painting plan 203A
Mounting B34L(E)

					SCALE	1:8		
ECM	LOC	SUMMARY OF MODIFICATIONS		EXECUTED	CHECKED	RELEASED	DATE	VER
EXECUTED	USERADMIN	THREE PHASE W40 MOTOR NEMA PREMIUM EFF						
CHECKED		FRAME 364/5TSC IP23 ODP						
RELEASED		WEG code: 14284844						
REL DT	15.04.2019	WMO	Jaragua do Sul	Product Engineering	SHEET	1 / 1		

100 HP 02 Poles 60Hz

A

