

F56C3/4S4C-MO

FARM DUTY ELECTRIC MOTOR
 HIGH STARTING TORQUE - MANUAL OVERLOAD
 SINGLE PHASE - CAPACITOR START / CAPACITOR RUN
 ROLLED STEEL CONSTRUCTION
 TOTALLY ENCLOSED FAN COOLED

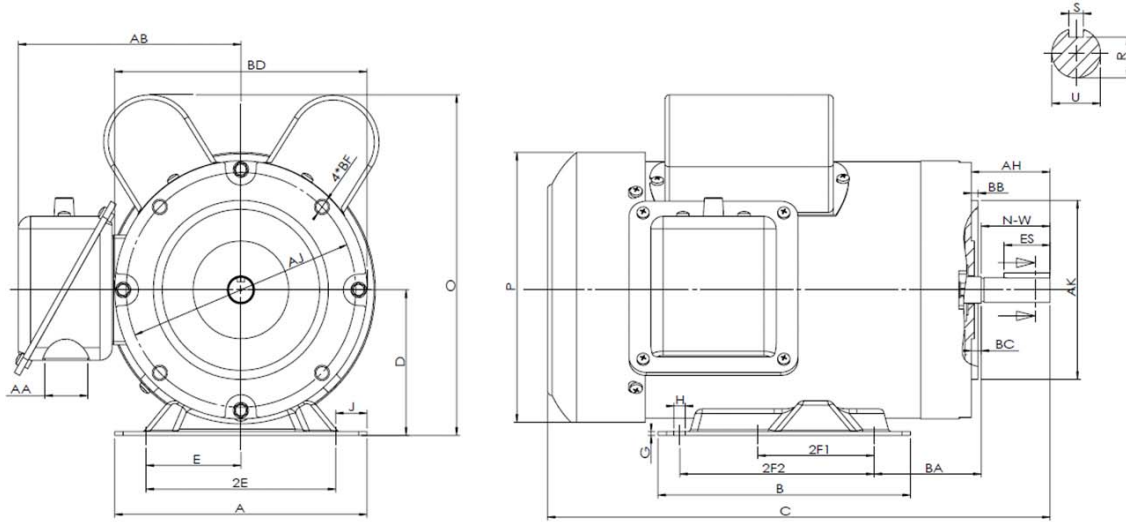

DIMENSIONS

HP	RPM	Frame	MOUNTING														
			A	B	C	D	G	H	J	E	2E	2F1	2F2	O	P	T	BA
3/4	1800	56C	6.3	4	11.5	3.5	0.12	0.34	0.71	2.44	4.88	3	NA	7.99	6.82	NA	2.75

FLANGE							Shaft Extension, Key Set						
AH	AJ	AK	BB	BC	BD	BF	U	V	R	S	ES	N-W	
2.06	5.875	4.5	0.16	0.19	6.46	4*3/8-16	0.625	NA	0.517	0.188	1.41	1.88	

Conduit Box		Bearings		Mount
AA	AB	DE	ODE	
1.1	5.75	6203-2RZC3	6203-2RZC3	F1

BEARING LUBRICATION: The bearings come lubricated with Mobil Polyrex EM Polyurea Grease.



F56C3/4S4C-MO

FARM DUTY ELECTRIC MOTOR
HIGH STARTING TORQUE - MANUAL OVERLOAD
SINGLE PHASE - CAPACITOR START / CAPACITOR RUN
ROLLED STEEL CONSTRUCTION
TOTALLY ENCLOSED FAN COOLED

PERFORMANCE DATA

HP	RPM	Frame	Voltage	Frequency (Hz)	Full Load S.F.	Insulation Class	NEMA Design	Slip (%)	NEMA Code	Enclosure Type	IP Rating	Max. Ambient
3/4	1760	56C	115/208-230V	60	1.15	F	L	2.2	L	TEFC	IP55	40°C

Amps (230V)		Efficiency (%)			Power Factor			Torque (ft-lb)			DE Bearing	ODE Bearing	Connection	Weight (lbs.)
FLA	LRA	100%	75%	50%	100%	75%	50%	FLT	LRT %	BDT %				
3.66	27.6	74.6	68.6	58.4	0.89	0.85	0.79	3.01	310	333	6203-2RZC3	6203-2RZC3	5 Lead/P1,P2	33

NAME PLATE

North American Electric, Inc.		FARM DUTY	
		HIGH STARTING TORQUE MANUAL OVERLOAD	
SINGLE PHASE ELECTRIC MOTOR			
MODEL	F56C3/4S4C-MO	HP	3/4
FRAME	56C	ENCL	TEFC
RPM	1760	PH	1
DESIGN	L	CLASS	F
DE BRG	6203-2RZC3	ODE BRG	6203-2RZC3
VOLT	115/208-230V	LBS	33
AMPS	7.33/4.05-3.66	DUTY	CONT
S.F. AMPS	7.78/4.09-3.96	MAX AMB	40°C
SERIAL NUMBER			
115V LOW VOLTAGE		208-230V HIGH VOLTAGE	
CCW	L1	CW	L1
(P1)		(P1)	
(P2)		(P2)	
(T3)		(T3)	
(T8)		(T8)	
(T2)		(T2)	
(T4)		(T4)	
(T5)		(T5)	
L2		L2	
(T4)		(T4)	
(T8)		(T8)	
Hernando, MS www.naemotors.com			
ISO9001 CERTIFIED		CE	
CS C US		CS C US	