

PRODUCT INFORMATION PACKET



Model No: C182D17FK2B

Catalog No: 108502.00

..3HP..1750RPM.182/145TC.TEFC.180V...CONT.40C.1.0SF.RIGID C.C182D17FK2B.....DC NEMA.....
SCR



Regal and Leeson are trademarks of Regal Beloit Corporation or one of its affiliated companies.

©2018 Regal Beloit Corporation, All Rights Reserved. MC017097E





Nameplate Specifications

Output HP	3 Hp	Output KW	2.2 kW
Voltage	180 V	Current	14.0 A
Speed	1750 rpm	Service Factor	1
Efficiency	88.8 %	Duty	Continuous
Insulation Class	H	Frame	182/145TC
Enclosure	Totally Enclosed Fan Cooled	Overload Protector	No
Ambient Temperature	40 °C	Drive End Bearing Size	6205
Opp Drive End Bearing Size	6204	UL	Recognized
CSA	Y	CE	N

Technical Specifications

Rotation	Reversible	Mounting	Rigid C base
Overall Length	19.60 in	Shaft Diameter	0.875 in
Shaft Extension	2.15 in		
Outline Drawing	033315		

This is an uncontrolled document once printed or downloaded and is subject to change without notice. Date Created: 10/15/2018

033315

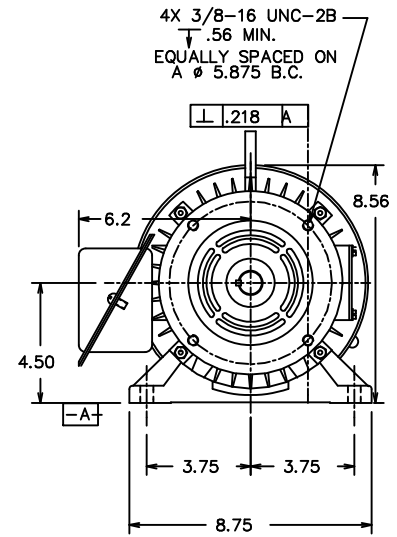
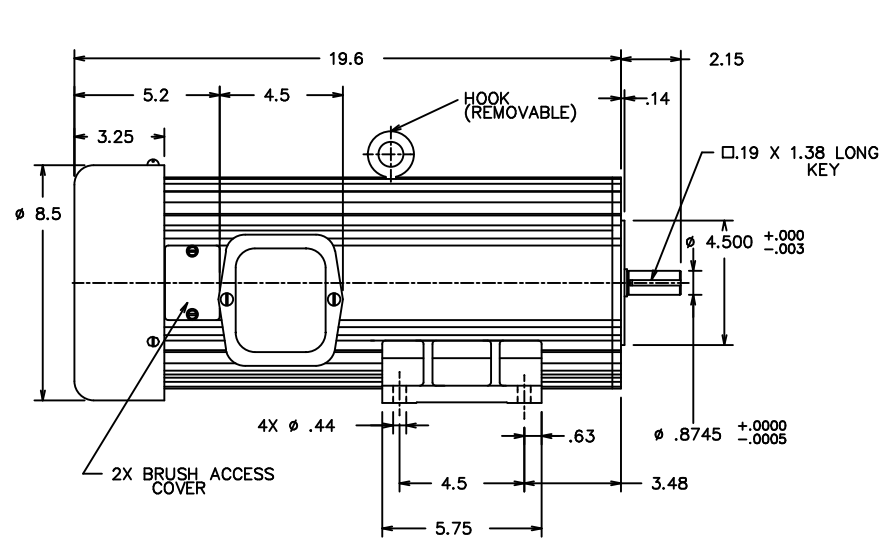
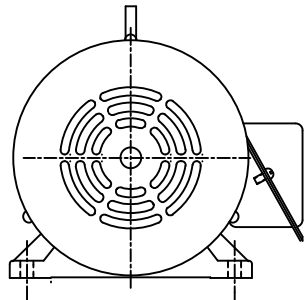

HP	3.0
FL AMPS	14.0
NL AMPS	.56
VOLTS	180
RPM	1750

		TOLERANCES UNLESS SPECIFIED		LEESON	ELECTRIC MOTORS GEARMOTORS AND DRIVES	DRAWN DLL 8/13/86	
		DEC.	INCHES			CHK	APPD
04	REDRAWN ON CAD	WMM	4/7/97	.X	±.1	TITLE	OUTLINE - 3 HP TEFC - DC MOTOR
03	REVISED PER SALES CN, EFF IMMED.	MMG	1/12/95	.XX	±.03		145TC FACE & 182 RIGID BASE
02	ADDED TABLE	MMG	6/13/94	.XXX	±.005	MAT'L	
01	LENGTH WAS 19"	JCW	11/17/86	.XXXX	±.0005	FINISH	
NO.	REVISION	BY & DATE	CHK	ANG	±1/2"	CAD FILE	033315
THIS DRAWING IN DESIGN AND DETAIL IS OUR PROPERTY AND MUST NOT BE USED EXCEPT IN CONNECTION WITH OUR WORK ALL RIGHTS OF DESIGN AND INVENTION ARE RESERVED THIS IS AN ELECTRONICALLY GENERATED DOCUMENT - DO NOT SCALE THIS PRINT				RFP		SIZE	DRAWING NO.
				DIST		B	033315
							REV. 04