

# PRODUCT INFORMATION PACKET



Model No: K1032  
Catalog No: K1032  
1/3 HP Jet Pump Motor, 1 phase, 3600 RPM, 230/115 V, 56C Frame, ODP  
Jet Pump Motors



Regal and Century are trademarks of Regal Beloit Corporation or one of its affiliated companies.  
©2019 Regal Beloit Corporation, All Rights Reserved. MC017097E

The REGAL logo consists of the word 'REGAL' in a bold, white, sans-serif font, set against a dark grey, trapezoidal background. This logo is positioned on a blue, vertically-oriented decorative bar that has a halftone dot pattern.



**Nameplate Specifications**

Output HP	1/3 Hp	Output KW	0.25 kW
Frequency	60 Hz	Voltage	230/115 V
Current	4.3/8.6 A	Speed	3450 rpm
Service Factor	1.8	Phase	1
Duty	Continuous	Insulation Class	B
Frame	56C	Enclosure	Open Drip Proof
Thermal Protection	Automatic	Ambient Temperature	40 °C
UL	Recognized	CSA	Y
CE	N		

**Technical Specifications**

Electrical Type	Capacitor Start Induction Run	Starting Method	Across The Line
Poles	2	Rotation	Reversible
Mounting	Round	Drive End Bearing	Ball
Opp Drive End Bearing	Ball	Frame Material	Rolled Steel
Shaft Type	Keyed	Overall Length	10.31 in
Frame Length	5.00 in	Shaft Diameter	0.625 in
Shaft Extension	2.06 in		

This is an uncontrolled document once printed or downloaded and is subject to change without notice. Date Created:30/10/2019

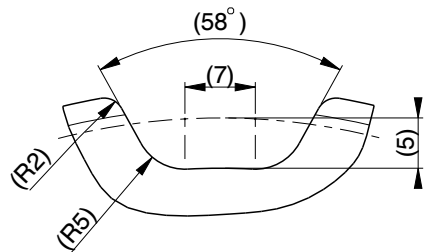

DETAIL: X  
SCALE 2:1

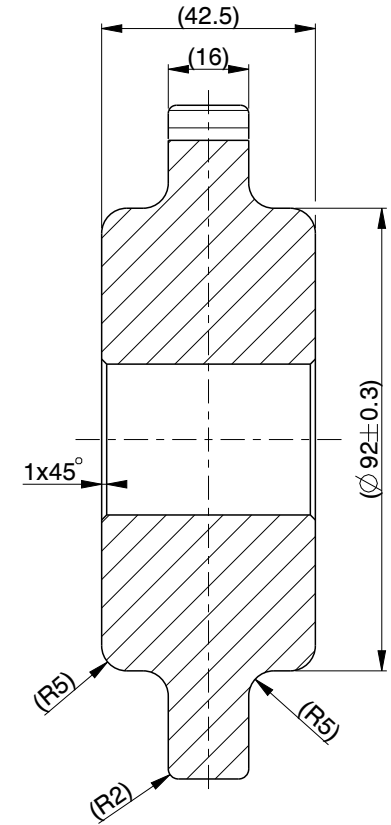
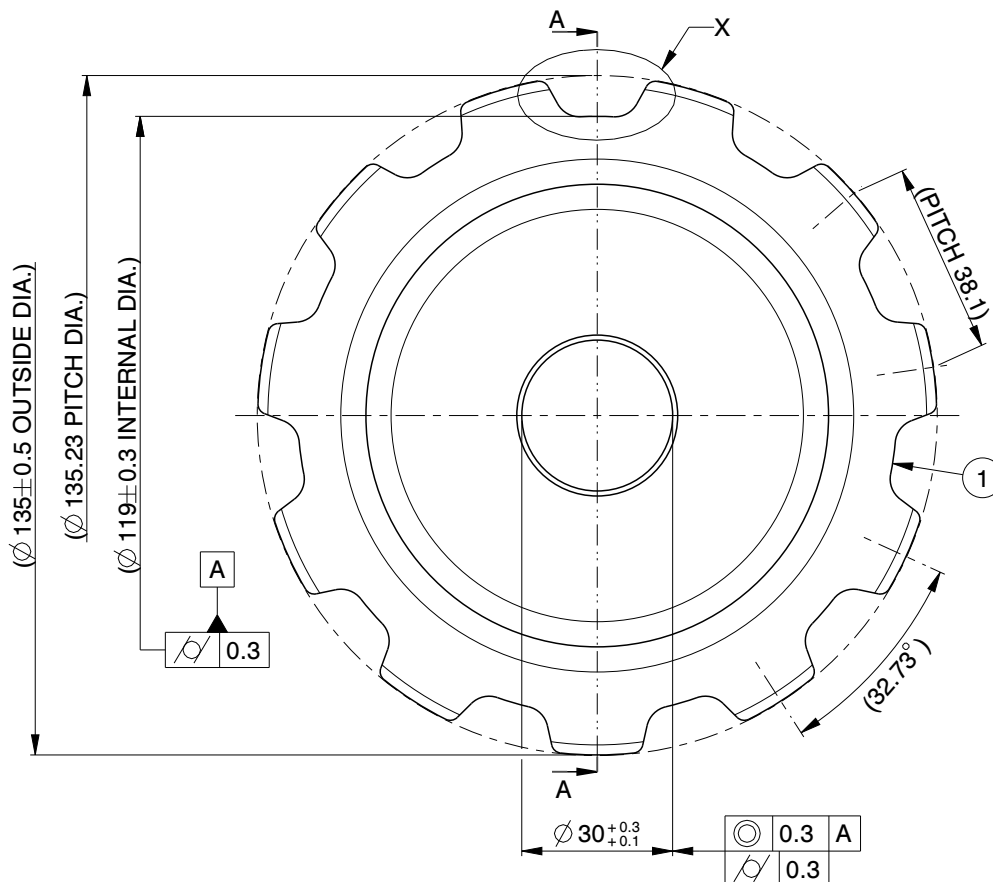

SECTION A-A

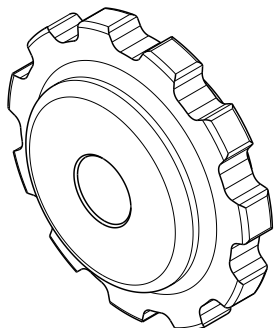

SCALE 1:2

Pos	Code	Description	Qty	Material	Color
1	12429G	880-11R18M-RM	1	---	---

Experimental code	<p>The 2D drawing is leading with respect to dimensions. For all dimensions not specifically mentioned refer to the 3D model.</p> <p>Unless individual indications, general tolerances according to ISO 2768-mK</p>	<p>POWER TRANSMISSION SOLUTIONS</p> <p>Confidential Property of Power Transmission Solutions</p> <p>By accepting this document you agree to the following: This document and the information it contains is the property of Power Transmission Solutions. It must be held in strict confidence and be properly safeguarded by you at all times. It may only be used for the specific purpose that it was loaned to you. It may not be revealed to another party without prior written authorization from Power Transmission Solutions.</p>	Drawn by	Description		
Material description			A.KOTKAR	880-11R30M-RM		
Material code			Date	Long description		
Material color			19/08/2014	SPROCKET		
Weight			NPI / ECN	Scale	Tool number	Sheet
397.3 g	C00570	1:1	---	1 of 1		
		Part number		Rev.		
		12430		A		

Do not scale drawing

# Uncontrolled Copy Released 5/22/2007

614621 SHT.#8

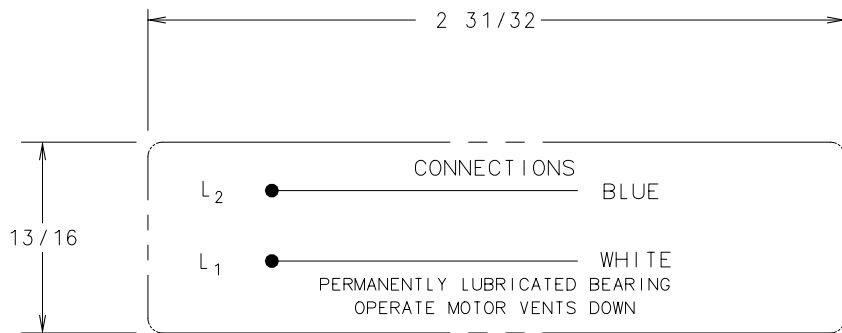

614621-029  
NPN#0344496

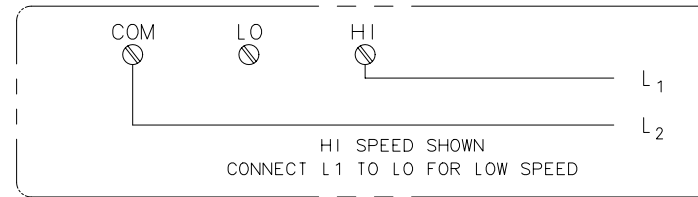

614621-030  
NPN# 0346529



614621-031  
NPN XXXXXXX



614621-032  
NPN XXXXXXX

**NOTES:**

- 1) FOR USE WITH 616231 NAMEPLATE BLANK
- 2) DIE MUST PRODUCE A LEGIBLE IMPRESSION
- 3) --- --- --- INDICATES DIMENSIONAL LIMITS. NO BOUNDRY LINES.

DATE	CHANGED FROM	APPROVED ENG DRF	NOTICE	DATE	CHANGED FROM	APPROVED ENG DRF	NOTICE	GEOMETRIC CHARACTERISTICS & SYMBOLS	UNLESS OTHERWISE SPECIFIED DIMENSION TOLERANCES ARE AS FOLLOWS	MATERIAL	DRAWN TDT 09/15/03	<b>A.O. SMITH</b> ELECTRICAL PRODUCTS CORPORATION TIPP CITY, OHIO COPYRIGHT 1995
				7/9/04	RELEASED -030	RH	TDT	□ FLATNESS — STRAIGHTNESS < ANGULARITY ⊥ PERPENDICULARITY (SQUARENESS) // PARALLELISM ○ ROUNDNESS (CIRCULARITY) ⊘ CYLINDRICITY ▭ PROFILE OF ANY SURFACE 2-PLACEMENT	INCHES .X .XX .XXX ±.02 ±.005 METRIC ±.5 ±.13 ANGLES ±.50 DEG REMOVE BURRS AND BREAK SHARP EDGES .003-.015, CORNER FILLETS TO .020 MACHINE SURFACES 125 ✓	-	APPROVED JW 11/06/03	DESCRIPTION <b>CONNECTION DIAGRAM</b> (EXTRENAL)
								CONFIDENTIAL: THIS DRAWING AND ITS INFORMATION ARE THE PROPERTY OF A.O. SMITH CORP. AND ARE NOT TO BE DISCLOSED, REPRODUCED, COPIED, OR TRANSMITTED IN ANY MANNER WITHOUT THE WRITTEN PERMISSION OF A.O. SMITH CORP.	PROCESS	REFERENCE	SIZE	PART NUMBER 614621