

PRODUCT INFORMATION PACKET



Model No: B698
Catalog No: B698
1.0 HP General Purpose Motor, 1 phase, 3600 RPM, 115/230 V, 56 Frame, TEFC
Single Phase TEFC Motors



Regal and Century are trademarks of Regal Beloit Corporation or one of its affiliated companies.
©2019 Regal Beloit Corporation, All Rights Reserved. MC017097E

The REGAL logo is a grey rectangular box with the word 'REGAL' in white, bold, uppercase letters. It is positioned on a blue and black halftone background that runs vertically down the right side of the page.

REGAL



Nameplate Specifications

Output HP	1.0 Hp	Output KW	0.75 kW
Frequency	60 Hz	Voltage	115/230 V
Current	12.0/6.0 A	Speed	3450 rpm
Service Factor	1	Phase	1
Duty	Continuous	Insulation Class	B
Frame	56	Enclosure	Totally Enclosed Fan Cooled
Thermal Protection	Automatic	Ambient Temperature	40 °C
UL	Recognized	CSA	Y
CE	N		

Technical Specifications

Electrical Type	Capacitor Start, Induction Run, Single Or Dual Voltage	Starting Method	Across The Line
Poles	2	Rotation	Reversible Counterclockwise
Mounting	Resilient Base	Drive End Bearing	Ball
Opp Drive End Bearing	Ball	Frame Material	Rolled Steel
Shaft Type	Keyed	Overall Length	12.61 in
Frame Length	5.13 in	Shaft Diameter	0.625 in
Shaft Extension	1.94 in		

This is an uncontrolled document once printed or downloaded and is subject to change without notice. Date Created:04/11/2019

WORM DATA

No. OF THREADS	4	$\sqrt{.005 C}$
PITCH DIA.	1.863	
DIAMETRAL PITCH	5.596 (REF)	
NORM. PRESSURE ANGLE	14-1/2°	
ADDENDUM	.223	
WHOLE DEPTH, REF.	.376	
LEAD ANGLE	20° 59' (REF)	
HAND	LH	
LEAD	2.2456	
AXIAL PITCH (REF)	.5614	
MAJOR DIAMETER	2.220	
MINOR DIAMETER		
MEAS. OVER PINS	2.1975/2.1925	
PIN DIAMETER	.269	

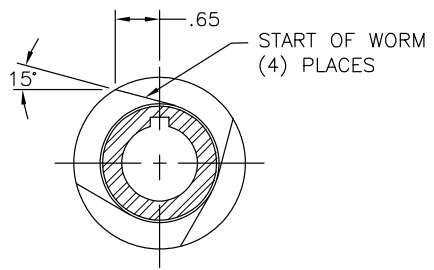

PART NO.	B698
ALT. DESC. OR EDP NO.	0206980022
ANMF SEQUENCE NO.	00136944

HEAT TREAT:
CASE HARDEN 50-55 Rc
.020 EFF. CASE DEPTH

SECTION "A-A"

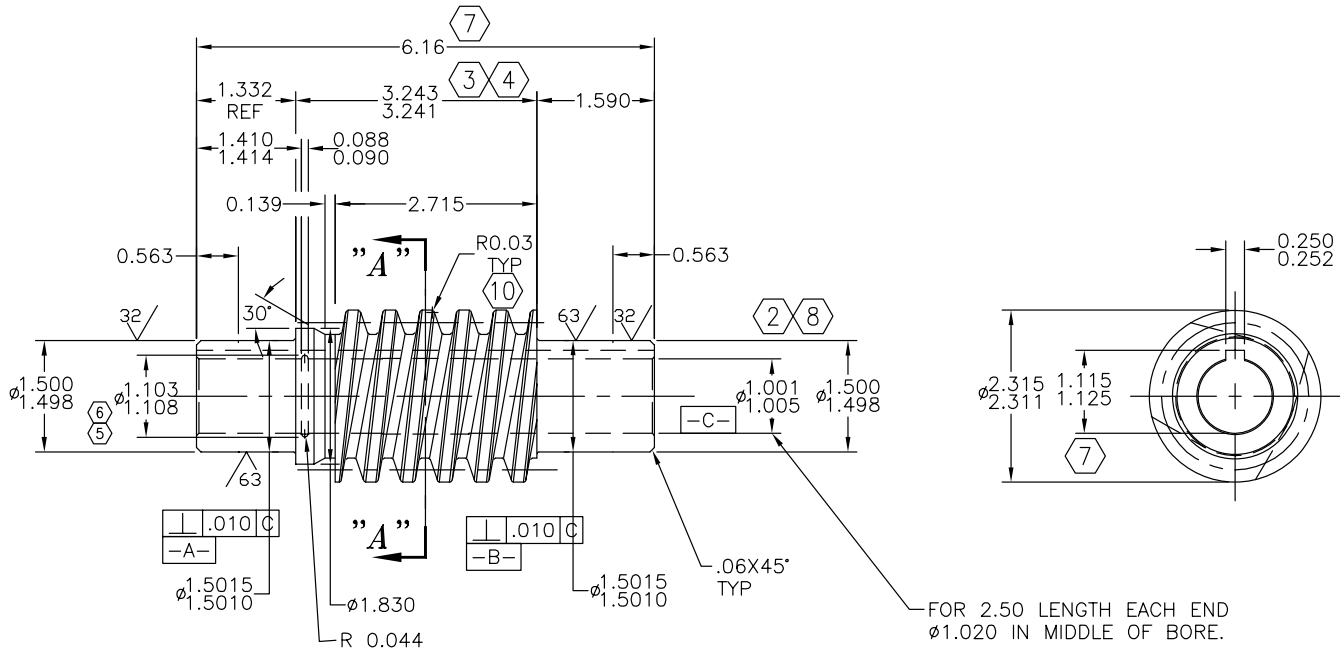

APPROX. WEIGHT 8.5 LBS.

REV.	W.O. NO.	ZONE	DESCRIPTION	BY	DATE	REV.	W.O. NO.	ZONE	DESCRIPTION	BY	DATE	ALL DIMENSIONS IN INCHES UNLESS OTHERWISE SPECIFIED	THIS PRINT IS CONFIDENTIAL AND IS THE PROPERTY OF DURST, DIV. REGAL-BELT CORP.	DURST DIVISION OF REGAL-BELT CORP. P.O. BOX 208 BELOIT, WISCONSIN 53511
10	27239	B2	ADDED .03R TYP	JLP	2/12/07	7	26097	C2	REVISED DIMENSION TOLERANCES	JLP	8/4/05	ALLOW 12 FINISH STOCK ON MACHINED SURFACES. FILLETS AND RADI 1/2 MAX. MACHINING: 12 GRADUES	THIS PRINT SHALL NOT BE USED, COPIED OR REPRODUCED IN WHOLE OR IN PART, NOR SHALL THE CONTENTS BE RECALC IN ANY MANNER TO ANYONE, UNLESS WRITTEN PERMISSION IS OBTAINED FROM DURST, DIV. REGAL-BELT CORP.	
9	27149	B2	2.220 WAS 2.315/2.314, DELETE 1.863 P.D. DIM	WEM	11/27/06	6	25570	B1	WAS 1.057/1.062	WM	7/16/04	X ± .030 FRACTION ± 1/64 XXX ± .010 ANGLE ± 30' XXX ± .005 129 FINISH	MATERIAL: 8620H WHERE USED: RMS0040 MODEL: A1021 WHERE USED: N/A	
8	26491	C3	1.001/1.005 DIA WAS 1.001/1.003	JLP	9/14/05	5	25053	B1	ADDED 1.057/1.062 DIA GROOVE	JLP	10/28/03	SCALE: NONE	TITLE: WORM, SHAFT - L.H. 5:1 PART NO.: B698 SIZE: C	
						4	25033	B2	DIM. 1.590 WAS 1.582	JLP	8/18/03	THIRD ANGLE PROJECT		
						3	24964	B2	DIM. 3.243/3.241 WAS 3.250/3.248	JLP	6/11/03			
						2	24775	B1	DIM. WAS 1.000/1.0015 DIA.	JLP	2/14/03			
						1	24346	N/A	DIM. WAS 1.998 DIA.	JLP	2/14/03			
									RELEASE TO PRODUCTION	JLP	9/23/02			

REF:
B31-235,B678-1

SHEET 1 OF 1